

COLLEGE OF GRADUATE STUDIES

**COURSE LISTING
SUMMER 2019**

May 20–August 15, 2019



**IMMACULATA
UNIVERSITY**

CLASS MEETING DATES

Summer 2019

SUMMER I - Monday, May 20 - Monday, July 1

<u>Monday</u>	<u>Wednesday</u>	<u>Tuesday</u>	<u>Thursday</u>
May 20	May 22	May 21	May 23
May 27 - OFF	May 29	May 28	May 30
June 3	June 5	June 4	June 6
June 10	June 12	June 11	June 13
June 17	June 19	June 18	June 20
June 24	June 26	June 25	June 27
July 1	-----	-----	-----

SUMMER FULL - Monday, May 20 -Thursday, August 15

<u>Monday</u>	<u>Tuesday</u>	<u>Wednesday</u>	<u>Thursday</u>
May 20	May 21	May 22	May 23
May 27 - OFF	May 28	May 29	May 30
June 3	June 4	June 5	June 6
June 10	June 11	June 12	June 13
June 17	June 18	June 19	June 20
June 24	June 25	June 26	June 27
July 1	July 2	July 3	July 4 - OFF
July 8	July 9	July 10	July 11
July 15	July 16	July 17	July 18
July 22	July 23	July 24	July 25
July 29	July 30	July 31	August 1
August 5	August 6	August 7	August 8
August 12	-----	-----	August 15

SUMMER II - Monday, July 8 - Thursday, August 15

<u>Monday</u>	<u>Wednesday</u>	<u>Tuesday</u>	<u>Thursday</u>
July 8	July 10	July 9	July 11
July 15	July 17	July 16	July 18
July 22	July 24	July 23	July 25
July 29	July 31	July 30	August 1
August 5	August 7	August 6	August 8
August 12	August 14	August 13	August 15

Immaculata University is committed to the principle of equal educational opportunity without unlawful discrimination because of an applicant's or student's race, gender, ethnicity, religion, age, national origin, color, disability, marital status, familial status, veteran status, ancestry, genetic characteristics, pregnancy, or other classifications protected by law or University policy.



**COLLEGE OF
GRADUATE STUDIES**

1145 King Road | Loyola Hall 130
Immaculata, PA 19345
Phone: 610-647-4400 x3211/3212
Fax: 610-993-8850

Dear Students:

We are pleased to invite new, continuing and prospective students to preview the Summer 2019 College of Graduate Studies Course Listing.

Immaculata University offers masters, doctoral, and certification programs in the areas of Education, Psychology, HealthCare and Business. All of our programs are rooted in academic rigor, ethical integrity, and Christian core values and encourage a commitment to lifelong learning and professional excellence. Students are supported by an engaged and professional faculty who create opportunities for growth through teaching-learning relationships, research, and service.

To meet student needs, graduate courses are offered face to face, online and hybrid. The course listing is arranged by department and provides specific details for each course offering. Course descriptions can be found in the Graduate Catalog available on the website at www.immaculata.edu/graduate.

Online registration begins on Monday, March 25 at 6:00 am. Directions for registering online can be found on page 13. The Summer 2019 semester begins on Monday, May 20, 2019.

New and current students needing assistance with registration may contact the Graduate Office at 484-323-3211 or graduate@immaculata.edu.

There is still time for prospective master level students to apply for the Summer semester. Apply online at www.immaculata.edu/gradapply or contact Sandra Rollison, Associate Dean at 484-323-3215 or srollison@immaculata.edu.

Wherever you are in your academic journey we are dedicated to helping you achieve your academic and professional goals!

Sincerely,

Dr. Thomas F. O'Brien
Dean, College of Graduate Studies

**REGISTRATION INFORMATION
SUMMER 2019**

Not A Current Student?
Interested in Taking A Course?
Call 610-647-4400, Ext. 3224 for Application Information
gradadmission@immaculata.edu

GENERAL INFORMATION:

The Summer 2019 registration process begins with the publication of this listing for graduate course offerings. Please refer to the “Class Meeting Dates” on the inside front cover for specific term dates.

TYPES OF REGISTRATION:

Online Registration: Graduate students may register online using (S.S. IU) - Self-Service Immaculata University. Please refer to Pages 13-15 for step-by-step instructions on “How to Register Online.”

Online registration will open at **6:00 a.m. on Monday, March 25, 2019**. Additionally, paper registrations will be entered by the office staff beginning on Monday, March 25, 2019. Online registrations are processed in “real time” (24/7) and paper registrations are processed during regular business hours in the order that they are received until the class limit has been reached. Wait lists will be managed through the Graduate Office. All financial obligations must be met prior to online registration and office registration.

ADVISEMENT:

The Graduate Office staff will submit your course selections to your advisor for review, approval and signature regardless of whether you register online or submit a paper registration.

If you would like to meet with your advisor prior to submitting course selections, please call as soon as possible to schedule an appointment.

DROP/ADD - WITHDRAWAL - REFUND POLICY:

Following the submission of either an official add/drop form or a withdrawal form (after the third session), tuition refunds for semester length courses are made on the following basis:

prior to first class.....	100%	after the third but prior to the fourth class.....	40%
after the first but prior to the second class.....	80%	after the fourth but prior to the fifth class.....	20%
after the second but prior to the third class.....	60%	after the fifth class.....	no refund

Students may add and drop classes online for Summer I and Summer Full until May 19, 2019. For Summer II session, you may add and drop classes online until July 7, 2019. Otherwise, you must process registration updates through the Graduate Office.

-Refund policies for 7 week courses can be found at <http://www.immaculata.edu/academics/registrar/refunds>.
-Refunds for special topics and other courses scheduled in special formats will be pro-rated.

COLLEGE OF GRADUATE STUDIES

Summer I 2019 Course Schedule Monday, May 20, 2019 - Monday, July 1, 2019

CORE/GENERAL PROGRAM SUPPORT COURSES

Dr. Marcia Parris, Associate Dean

CRN	COURSE NO. AND TITLE	CREDIT	DAY/TIME	LOCATION	INSTRUCTOR
50235	GEN 503 A Interpersonal Relations	3	M W 4:30-7:10	116 LH	Dr. Suzann Steadman

EDUCATIONAL LEADERSHIP

Dr. Patricia Madeira, Director

CRN	COURSE NO. AND TITLE	CREDIT	DAY/TIME	LOCATION	INSTRUCTOR
50108	EDL 640 Instructional Accommodations (hybrid)	3	M 4:30-8:30 FF: 5/20; 6/3, 17; 7/1 OL: 5/27; 6/10, 24	221 LH	Dr. Karen Miscavage

DOCTOR OF EDUCATION-K-12-LEADERSHIP

Sr. Carol Anne Couchara, Director

CRN	COURSE NO. AND TITLE	CREDIT	DAY/TIME	LOCATION	INSTRUCTOR
50041	EDL 730 Pupil Personnel Services	3	Log into Moodle Th, 5/23 by 10:00 pm	Online	Dr. Thomas O'Brien
50021	EDL 735 The Superintendency	3	Th 5:00-9:00 5/16, 23, 30; 6/6, 13, 20	219 LH	Dr. Marc Bertrando

CLINICAL MENTAL HEALTH COUNSELING SCHOOL PSYCHOLOGY

***Dr. Tracy Stinchfield, Director
Dr. Marie McGrath, Director***

CRN	COURSE NO. AND TITLE	CREDIT	DAY/TIME	LOCATION	INSTRUCTOR
50040	PSYC511 B Topics in Psychology: Psychopharmacology: Medication Uses and Side Effects	3	M W 7:20-10:00	116 LH	Dr. Christine Moriconi

This course will provide an overview of commonly prescribed medications for psychological disorders with an emphasis on current research and drugs used for those with a diagnosis of addictions or addictions with co-occurring illnesses. Readings and lectures will address how the medications work, their uses and side effects. This interactive seminar offers the opportunity to enhance the students' and clinicians' knowledge of their clients' medications, which will contribute to the success of each client's assessment and treatment.

50085	PSYC511 C Topics in Psychology: Proactive Grief Counseling Strategies	1	F 5/31 4:00-9:00 Sa 6/1 8:00-5:00	116 LH	Dr. David Martinson
-------	--	---	--------------------------------------	--------	---------------------

This course will provide specialized instruction for students in the Clinical Mental Health Counseling Program. Students will learn proactive counseling strategies for assisting clients who are experiencing complicated grief and loss due to death, suicide, or traumatic loss. The course will discuss relevant theories, literature, and research focusing on strategies for assisting clients facing these major life changes.

50256	PSYC 610 Children with Exceptional Needs	3	T Th 7:20 – 10:00	120 LH	Tammy Campli, MA
50234	PSYC 642 Instruction & Assessment of Culturally & Linguistically Diverse Learners	3	T Th 4:30-7:10	120 LH	Tammy Campli, MA

DOCTOR OF CLINICAL PSYCHOLOGY

Dr. Jed Yalof, ABPP, Chair

CRN	COURSE NO. AND TITLE	CREDIT	DAY/TIME	LOCATION	INSTRUCTOR
50218	PSYC 713A History & Systems in Psychology	3	T Th 7:20-10:00	121 LH	Dr. Edward Jenny
50219	PSYC 713B History & Systems in Psychology	3	T Th 7:20-10:00	120 LH	Dr. Jillian Threadgill
50220	PSYC 731A Assessment V: Neuropsychological	3	T Th 4:30-7:10	123 LH	Dr. Julie Keaveney

Summer Full 2019 Course Schedule Monday, May 20, 2019 – Thursday, August 15, 2019

CORE/GENERAL PROGRAM SUPPORT COURSES

Dr. Marcia Parris, Associate Dean

CRN	COURSE NO. AND TITLE	CREDIT	DAY/TIME	LOCATION	INSTRUCTOR
50236	GEN 501A Human Development	3	Log into Moodle W 5/22 by 10:00 pm	Online	Dr. Fran Rassouli
50237	GEN 502 Methods of Research	3	Log into Moodle T 5/21 by 10:00 pm	Online	Dr. Kathryn Soeder
50238	GEN 503B Interpersonal Relations	3	Log into Moodle T 5/21 by 10:00 pm	Online	Dr. Stephen Catrambone

EDUCATIONAL LEADERSHIP

Dr. Patricia Madeira, Director

CRN	COURSE NO. AND TITLE	CREDIT	DAY/TIME	LOCATION	INSTRUCTOR
50008	EDL 599 Comprehensive Examination	0	Return no later than Monday July 8 to the Graduate Office.		
50054	EDL 626 School Community Relations	3	Log into Moodle W 5/22 by 10:00 pm	Online	Dr. Christopher Harrington
50051	EDL 653 Low Incidence Disabilities (Hybrid)	3	W 4:30-8:30 FF: 6/26; 7/17, 24; 8/7 OL: 7/3, 10, 31	221 LH	Dr. Karen Miscavage
50053	EDL 654 Foundations of Integrative STEM Education (Hybrid)	3	W 4:30-8:30 FF: 6/26; 7/10, 24; 8/7 OL: 7/3, 17, 31	220 LH	Nancy Acconciamesa, MA
50055	EDL 661 Literacy in Education	3	Log into Moodle Su 5/19 by 10:00 pm	Online	Dr. Amy Martell
50056	EDL 662 Instructional Strategies for Standards Aligned Curriculum in Mathematics	3	Log into Moodle M 5/20 by 10:00 pm	Online	Dr. Melissa Bream

DOCTOR OF EDUCATION-K-12-LEADERSHIP

Sr. Carol Anne Couchara, Director

CRN	COURSE NO. AND TITLE	CREDIT	DAY/TIME	LOCATION	INSTRUCTOR
50042	EDL 723 School Business Management	3	T 5:00-9:00 5/21, 28; 6/4, 11, 18, 25; 7/9	221 LH	Dr. Joseph O'Brien
50043	EDL 724 Organizational Development & Change Theory	3	W 4:00-8:00 5/22, 29; 6/5, 12, 19, 26; 7/10	216 LH	Dr. Joseph Corabi
50044	EDL 734 Dissertation Research Seminar (Hybrid) (Open only to students who have completed EDL 797)		T 4:30-7:10	216 LH	Dr. Christopher Harrington
	EDL 798, 799, 800 Dissertation I, II, III *	3, 3, 3	By arrangement with Dissertation Chair.		
	EDL 000 Dissertation Continuation *	0	Open only to students having completed EDL 798, 799 & 800. Fee equivalent to one doctoral credit: \$955 (first enrollment) Fee equivalent to three doctoral credits: \$2,865 (subsequent enrollment)		

*Dissertation students will receive their CRN number via Immaculata email. Registration questions may be directed to ext. 3215.

DOCTOR OF EDUCATION-HIGHER EDUCATION***Sr. Ann Heath, Director***

Reminder: HED 766 Introduction to Doctoral Competencies and Professional Ethics will be offered online from 5/3 – 5/18 with one meeting on Saturday, May 4 from 9:00 am – 5:00 pm. This course is listed in the Spring Course Listing under CRN 10194. Please contact the Graduate Office if you want to add/drop this course.

CRN	COURSE NO. AND TITLE	CREDIT	DAY/TIME	LOCATION	INSTRUCTOR
50245	HED 732 Assessment of Student Learning Outcomes (Hybrid course. Online: May 20 thru June 16.)	3	Sa Su 6/1, 2 9:00-5:00	103 LH	Dr. David Parkyn
50246	HED 750 Student Services in Higher Education (Hybrid course. Online: June 17 thru July 14.)	3	Sa Su 6/22, 23 9:00-5:00	103 LH	Dr. Gregory Naylor
50247	HED 765 Current Issues in Nursing Education (Hybrid course. Online: May 20 thru July 14.)	3	Sa 6/1 9:00-5:00 Sa 6/22 9:00-5:00	100 LH	Staff
50248	HED 772 Learning Theory & Practice for Classroom & Clinical Nursing Education (Hybrid course. Online: May 20 thru July 14.)	3	Su 6/2 9:00-5:00 Su 6/23 9:00-5:00	123 LH	Dr. Maria Toth
50249	HED 773 Advanced Scientific Inquiry in Nursing & Health Care (Hybrid course. Online May 20 thru July 14.)	3	Sa 6/1 9:00-5:00 Sa 6/22 9:00-5:00	121 LH	Dr. Mary Powell
	HED 798 Dissertation I *	3	By arrangement with Dissertation Chair		
	HED 799 Dissertation II *	3	By arrangement with Dissertation Chair		
	HED 800 Dissertation III*	3	By arrangement with Dissertation Chair		
	HED 000 Dissertation Continuation *	0	Open only to students having completed HED 798, 799 & 800. Fee equivalent to one doctoral credit: \$955 (first enrollment) Fee equivalent to three doctoral credits: \$2,865 (subsequent enrollment)		

*Dissertation students will receive their CRN number via Immaculata email. Registration questions may be directed to ext. 3215.

MANAGEMENT AND LEADERSHIP***Dr. Janice Jacobs, Director***

Pre-course assignments will be posted on Moodle at least one week prior to course start date. In addition to campus meetings, instruction will be delivered through Moodle.

CRN	COURSE NO. AND TITLE	CREDIT	DAY/TIME	LOCATION	INSTRUCTOR
50241	MML 600 Leadership Foundations (Hybrid)	3	W 6:00-10:00 5/22; 6/5, 19; 7/3, 31; 8/7	102 LH	Dr. Janice Jacobs
50242	MML 612 Leadership Ethics: Sustainability & Transparency in Organizations (Hybrid)	3	T 6:00-10:00 6/4, 18; 7/2, 16, 30; 8/13	102 LH	Sue Petrocelli, MA
50243	MML 615 Leveraging Emerging Technologies & Cybersecurity (Hybrid)	3	T 6:00-10:00 5/28; 6/11, 25; 7/9, 23; 8/6	100 LH	Luis Colmenares, MBA
50244	MML 635 MML Comprehensive (hybrid)	0	T 6:00 10:00 5/21; 6/11; 7/9, 30; 8/6	220 LH	Dr. Janice Jacobs
50254	MML 696 Conflict Resolution (hybrid)	1	H 6:00- 8:30 pm 5/23; 6/6, 6/20	100 LH	Dr. Brian Peterson

MUSIC THERAPY***Corey Olver, MA, MT-BC, LPC, Director***

CRN	COURSE NO. AND TITLE	CREDIT	DAY/TIME	LOCATION	INSTRUCTOR
50231	MUT 504 Theories & Practices in Medical Music Therapy	3	F Sa Su 9:00-6:00 5/31; 6/1, 2 Sa Su 9:00-6:00 6/22, 23	208 VM	Staff
50232	MUT 506 Theories & Practices in Psychiatric Music Therapy (Hybrid. Online as assigned.)	3	Sa Su 9:00-6:00 6/29, 30; 7/27, 28	208 VM	Corey Olver, MA, MT-BC, LPC
50109	MUT 512 Clinical Training I - Integrating Theory & Prac	1	T 5:00 – 6:00	20 GC	Daniel Benonis, MA, MT-BC
50110	MUT 513 Clinical Training II - Integrating Theory & Prac	1	T 5:00 – 6:00	20 GC	Daniel Benonis, MA, MT-BC

50111	MUT 514	Clinical Training III - Integrating Theory & Prac	1	T	5:00 – 6:00	20 GC	Daniel Benonis, MA, MT-BC
-------	---------	---	---	---	-------------	-------	---------------------------

PART-TIME*:

50112	MUT 521	Graduate Internship I	2	T	6:30 – 7:30	Conference Call	Daniel Benonis, MA, MT-BC
50113	MUT 522	Graduate Internship II	2	T	6:30 – 7:30	Conference Call	Daniel Benonis, MA, MT-BC
50114	MUT 523	Graduate Internship III	2	T	6:30 – 7:30	Conference Call	Daniel Benonis, MA, MT-BC

FULL-TIME*:

50116	MUT 524	Graduate Internship I	2	T	6:30 – 7:30	Conference Call	Daniel Benonis, MA, MT-BC
50117	MUT 525	Graduate Internship II	2	T	6:30 – 7:30	Conference Call	Daniel Benonis, MA, MT-BC

Notes: -*Seminars include both on-campus and conference call meetings. Additional meetings may be arranged.
 -Schedule and location of on-site clinical training to be arranged. Contact Corey Olver at colver@immaculata.edu. Must register through the College of Graduate Studies.

CRN	COURSE NO. AND TITLE	CREDIT	DAY/TIME	LOCATION	INSTRUCTOR
50118	MUT 530 Music Skills for Therapy - Piano	1	By arrangement		Laurie Schrecengost, MA
50119	MUT 532 Music Skills for Therapy - Guitar	1	By arrangement		Dr. Bryan Muller
50120	MUT 534 Music Skills for Therapy - Voice	1	By arrangement		Erika Maguire, MA, MT-BC

Please discuss individual music skills requirements with Corey Olver prior to registration: colver@immaculata.edu

50010	MUT 599	Comprehensive Examination	0	Return no later than Monday, July 8 to the Graduate Office.		
50233	MUT 601	Advanced Resources for Music Therapy	3	Sa 6/1 9:00-6:00 Sa Su 7/20, 21 9:00-6:00	20 GC	Christine Gallagher
50121	MUT 610	Advanced Music Therapy Practicum	1	W 6:30–7:30	Conference Call	Corey Olver, MA, MT-BC, LPC
50122	MUT 621	Advanced Music Therapy Internship I	1	W 6:30 – 7:30	Conference Call	Corey Olver, MA, MT-BC, LPC
50123	MUT 622	Advanced Music Therapy Internship II	1	W 6:30 – 7:30	Conference Call	Corey Olver, MA, MT-BC, LPC

Students scheduled for MUT 610, 621, 622 will participate in a weekly supervision conference call and periodic on-campus meetings. Please contact Corey Olver at colver@immaculata.edu.

50125	MUT 630	Advanced Music Skills for Therapy	1	By arrangement. Please contact Corey Olver at colver@immaculata.edu .		
50127	MUT 690	Culminating Project in Music Therapy	3	By arrangement. Please contact Corey Olver at colver@immaculata.edu .		

NURSING

Dr. Pamela Hudson, Director

CRN	COURSE NO. AND TITLE	CREDIT	DAY/TIME	LOCATION	INSTRUCTOR	
50240	NURS 640	Advanced Health Assessment	3	F Sa 8:00-4:00 7/19, 20 F Sa 8:00-4:00 8/2, 3	2 LH	Dr. Maria Toth
50239	NURS 645	Advanced Pathopharmacology (Hybrid)	3	W 5:00-9:00 5/22; 6/5, 12, 26; 7/3, 17, 24, 31	14 LH	Dr. Susan Savini

NUTRITION EDUCATION

Dr. Qian Jia, Director

CRN	COURSE NO. AND TITLE	CREDIT	DAY/TIME	LOCATION	INSTRUCTOR
50011	NED 663	Internship Experience in Nutrition II	3	By arrangement with Dr. Danielle Kronmuller, MA, RD, LDN	
50012	NED 664	Internship Experience in Nutrition III	3	By arrangement with Dr. Danielle Kronmuller, MA, RD, LDN	

**CLINICAL MENTAL HEALTH COUNSELING
SCHOOL PSYCHOLOGY**

**Dr. Tracy Stinchfield, Director
Dr. Marie McGrath, Director**

CRN	COURSE NO. AND TITLE	CREDIT	DAY/TIME	LOCATION	INSTRUCTOR
50039	PSYC511A Topics in Psychology: Introduction to Play Therapy	3	M 7:20-10:00	121 LH	Dr. Kristy Brumfield

This course will provide an overview of the essential elements and principles of play therapy, including history, theories, modalities, techniques, applications and skills. An experiential component will focus on basic play therapy skill development within the context of ethical and diversity-sensitive practice. This course is designed to provide students with instruction in history, theories and applications of play therapy consistent with APT requirements for instruction in these areas, and as such, will provide 67.5 Continuing Education (CE) hours toward the Registered Play Therapist credential.

50086	PSYC511D Topics in Psychology: Trauma and Addiction	1	F 6/28 4:00-9:00 Sa 6/29 8:00-5:00	116 LH	Jane Brown, MA
-------	--	---	---------------------------------------	--------	----------------

This course will address the increasing incidence of trauma and abuse among addicted individuals presenting with mental health issues and barriers to recovery. It will explore the scope of the problem, tools for assessment, evaluation, treatment planning and resources for recovery and trauma resolution among addicted individuals.

50009	COUN 599 Comprehensive Examination	0	Return no later than Monday, July 8 to Graduate Office.		
50022	COUN 600 Research & Program Evaluation	3	Th 4:30-7:10	116 LH	Dr. David Hunt
50023	COUN 601 Counseling Skills & Techniques	3	M 4:30-7:10	123 LH	Dr. Rachel Vannatta
50024	COUN 602 Theories of Counseling	3	M 4:30-7:10	102 LH	Rosemarie Kurtz, MA
50025	COUN 604 Group Process	3	M 7:20-10:00	123 LH	Dr. Rachel Vannatta
50026	COUN 606 Family Counseling	3	T 4:30-7:10	121 LH	Dr. David Martinson
50027	COUN 608 Psychopathology	3	Th 4:30-7:10	102 LH	Shelby Krupka, MA
50028	COUN 609 Career & Vocational Counseling	3	W 4:30-7:10	219 LH	Dr. David Hunt
50029	COUN 614 Substance Abuse Education & Counseling	3	Th 4:30-7:10	333 LH	Dr. Deneen Miller
50030	COUN 618 Professional Orientation & Ethical Issues	3	M 7:20-10:00	120 LH	Abby Connor, MA
50035	COUN 630 Crisis Intervention & Trauma	3	W 4:30-7:10	121 LH	Dr. David Martinson
50037	COUN 640 Diversity Counseling	3	T 4:30-7:10	219 LH	Dr. Kristy Brumfield
50038	COUN 641 Assessment for Counselors	3	T 7:20-10:00	116 LH	Staff
50013	COUN 691 Practicum in Clinical Mental Health Counseling	3	M 4:30-7:10	TBA	Seminar Faculty*
50014	COUN 692 Internship I in Clinical Mental Health Counseling	3	M 4:30-7:10	TBA	Seminar Faculty*
50015	COUN 693 Internship II in Clinical Mental Health Counseling	3	M 4:30-7:10	TBA	Seminar Faculty*

*Seminar faculty includes Dr. Stinchfield, Dr. Miller, Dr. Brumfield, Dr. Martinson, and Abby Connor. Section assignments will be emailed one week prior to start of class.

PSYCHOLOGY PRACTICUM/INTERNSHIP PAPERWORK:

The deadline for practicum paperwork to be submitted is as follows:

Summer Term: January 20 Fall Term: June 1 Spring Term: September 10

Students can access practicum information online by logging in through the MyIU portal and accessing Moodle.

DOCTOR OF CLINICAL PSYCHOLOGY**Dr. Jed Yalof, ABPP, Chair**

CRN	COURSE NO. AND TITLE	CREDIT	DAY/TIME	LOCATION	INSTRUCTOR
50131	PSYC 697 Clinical Comprehensive Examination	0	Petition must be on file. Be sure to register as well.		
50221	PSYC 702A Professional Issues & Ethics	3	M 7:20-10:00	118 LH	Dr. Ashley Higgins
50222	PSYC 702B Professional Issues & Ethics	3	M 7:20-10:00	333 LH	Dr. Roger Osmun
50223	PSYC 705A Human Development	3	T 4:30-7:10	116 LH	Dr. Janet Etzi
50224	PSYC 705B Human Development	3	T 4:30-7:10	118 LH	Dr. Dawn Kriebel
50225	PSYC 709A Group Dynamics	3	M 4:30-7:10	216 LH	Dr. Sheetal Duggal
50226	PSYC 709B Group Dynamics	3	M 4:30-7:10	333 LH	Staff
50227	PSYC 731B Assessment V: Neuropsychological	3	T 7:20-10:00	123 LH	Dr. Julie Keaveney
50228	PSYC 740A Clinical Psychopharmacology	3	Th 7:20-10:00	116 LH	Dr. Christine Moriconi
50229	PSYC 740B Clinical Psychopharmacology	3	Th 7:20-10:00	118 LH	Dr. Daniel Orr
50230	PSYC 741 Clinical Supervision, Consultation & Mgmt	3	W 7:20-10:00	118 LH	Dr. Francien Richardson
50132	PSYC 797 Comprehensive Examination	0	Petition must be filed in the Graduate Office.		

Practicum/Seminar:

50016	PSYC 704 Pre-Practicum Seminar *	0			
-------	----------------------------------	---	--	--	--

*This is an as-needed course for students who are beginning their first practicum before the scheduled start date. Please contact Sr. Monica Acri: ecacri@immaculata.edu if you plan to register for PSYC 704

50133	PSYC 716 A Practicum & Seminar III	3	W 4:30-7:10	TBA	Seminar Faculty*
50134	PSYC 716 B Practicum & Seminar III	3	Th 4:30-7:10	TBA	Seminar Faculty*
50136	PSYC 725 A Practicum & Seminar VI	3	W 4:30 – 7:10	TBA	Seminar Faculty*
50138	PSYC 725 B Practicum & Seminar VI	3	Th 4:30-7:10	TBA	Seminar Faculty*
50017	PSYC 784 Practicum Continuation	0	As needed per advisement		Sr. Monica Acri

*Section assignments will be emailed approximately one week prior to start of class.

Internship:

PSYC 786	Internship in Clinical Psychology I	1.5	By arrangement with Internship Coordinator		
PSYC 792	Internship in Clinical Psychology V	1.5	By arrangement with Internship Coordinator		
PSYC 793	Internship in Clinical Psychology VI	1.5	By arrangement with Internship Coordinator		

*Internship students will receive their CRN number via Immaculata email. Registration questions may be directed to ext. 3214.

Dissertation:

PSYC 799	Doctoral Dissertation II *	3	By arrangement with Dissertation Chair.		
PSYC 000	Dissertation Continuation *	0	Open only to students having completed PSYC 798, 799 & 800. Fee equivalent to one doctoral credit: \$990 (1 st enrollment) Fee equivalent to three doctoral credits: \$2970 (subsequent enrollment)		

*Dissertation students will receive their CRN number via Immaculata email. Registration questions may be directed to ext. 3215.

Summer II – 2019 Course Schedule
Monday, July 8, 2019 - Thursday, August 15, 2019

CORE/GENERAL PROGRAM SUPPORT COURSES

Dr. Marcia Parris, Assistant Dean

CRN	COURSE NO. AND TITLE	CREDIT	DAY/TIME	LOCATION	INSTRUCTOR
50251	GEN 501B Human Development	3	T Th 7:20-10:00	121 LH	Dr. Thomas Castner

EDUCATIONAL LEADERSHIP

Dr. Patricia Madeira, Director

CRN	COURSE NO. AND TITLE	CREDIT	DAY/TIME	LOCATION	INSTRUCTOR
50211	EDL 615 Contemporary Professional Ethics	3	Log into Moodle M 7/8 by 10:00 pm	Online	Dr. Thomas O'Brien
50213	EDL 621 Administration	3	July 8-12 8:00-4:00	216 LH	Dr. Joseph Corabi
50214	EDL 622 Curriculum and Instruction	3	July 15-19 8:00-4:00	216 LH	Dr. Joseph Corabi
50212	EDL 623 Supervision	3	July 15-19 8:00-4:00	221 LH	Dr. Peggy Schooling
50215	EDL 625 School Law and Legal Process	3	July 22-26 8:00 – 4:00	221 LH	Michele Ruhl, MA

DOCTOR OF EDUCATION-K-12 LEADERSHIP

Sr. Carol Anne Couchara, Director

CRN	COURSE NO. AND TITLE	CREDIT	DAY/TIME	LOCATION	INSTRUCTOR
50045	EDL 726 Political, Economic, and Social Structures of the Culture (online)	3	Log into Moodle M 7/8 by 10:00 pm		Dr. Siobhan Leavy

NOTES: The University reserves the right to change the courses offered, enrollment caps, times, and faculty. All classes have limited enrollment. You are encouraged to register early.

The College of Graduate Studies supports and encourages the use of technology as a part of the learning process.

Immaculata University - Projected Fall 2019 Course Offerings **Monday, August 26, 2019 – Thursday, December 5, 2019**

Core Curriculum:

GEN501 Human Development
GEN502 Methods of Research
GEN503 Interpersonal Relations

Clinical Mental Health Counseling/School Psychology:

COUN600 Research and Program Evaluation
COUN601 Counseling Skills and Techniques
COUN602 Theories of Counseling
COUN604 Group Process
COUN606 Family Counseling
COUN608 Psychopathology
COUN609 Career & Vocational Counseling
COUN614 Substance Abuse Education and Counseling
COUN618 Professional Orientation and Ethical Issues
COUN630 Crisis Intervention & Trauma
COUN640 Diversity Counseling
COUN641 Assessment for Counselors
COUN691/692/693 Practicum/Internship in CMHC
COUN694 Seminar in Elem/Secondary Counseling
PSYC607 Treatment of Children & Adolescents
PSYC680 Seminar I: School Psychology Internship

Doctor of Psychology – Clinical:

PSYC608 Psychopathology
PSYC697 Clinical MA – Comprehensive Exam
PSYC698 Professional Development Series
PSYC701 Cognitive & Affective Bases of Behavior
PSYC703 Tests and Measurements
PSYC706 Research & Statistics I
PSYC708 Advanced Psychopathology
PSYC711 Psychoanalytic Theories & Therapies
PSYC712 Client-Center & Relationship Theories & Therapies
PSYC714 Practicum & Seminar I
PSYC717 Practicum & Seminar IV
PSYC726 Practicum & Seminar VII
PSYC729 Assessment II: Personality
PSYC 790 Dissertation Research Seminar
PSYC799 Doctoral Dissertation II
Clinical Internships

Nursing:

NURS621 Role Dev for Adv Nursing Practice
NURS690 MSN Capstone

Nutrition Education:

NED511 Special Topics in Nutrition
NED641 Applied Nutrition & Metabolism: Macronutrients
NED645 Medical Nutrition Therapy I
NED659 Preparation for Internship
NED662 Internship Experience in Nutrition I
NED691 Nutrition Capstone

Doctor of Education - Higher Education:

HED702 Methods of Research
HED704 Qualitative and Mixed Methods Research Design
HED725 Finance and Strategic Planning
HED765 Adv Topics: Current Issues in Nursing Education

HED798-799-800 Dissertation I, II, III
HED820 Applied Field Experience

Educational Leadership:

EDL591 Modified Student Teaching
EDL592 Student Teaching
EDL599 Comprehensive Examination
EDL613 Testing & Assessment
EDL614 Instructional Needs of ELL
EDL620 Curriculum Applications
EDL621 Administration
EDL625 School Law & the Legal Process
EDL629 Introduction to Special Education
EDL634 Content Area Reading
EDL637 Technology in Education
EDL643 Special Education for School Leaders
EDL651 Procedures/Processes in Special Education
EDL654 Foundations of Integrative STEM Education K-12
EDL 655 Curr., Inst., and Assess. in STEM Education K-12
EDL658 STEM Integ. And App. in the Classroom
EDL660 Instr. Strategies for Standards Aligned Curric.
in Literacy
EDL664 Literacy Assessment & Intervention
EDL690/EDL693 Practicum/Internship

Doctor of Education – K-12:

EDL720 Orientation to Doctoral Research
EDL725 Communication Theory & Practice
EDL727 Pennsylvania Sch Code & Sch Board Policies
EDL728 Curriculum Theory & Evaluation
EDL729 Curriculum Management
EDL789 Clinical Experience
EDL797 Comprehensive Examination
EDL798-799-800 Dissertation I, II or III

Music Therapy:

MUT500 Theoretical Orientations to MT
MUT512,513,514 Clinical Training
MUT521,522,523 Graduate Internships I, II, III
MUT524,525 Graduate Internships I, II
MUT530,532,534 Music Skills for Therapy
MUT609 MT Practice with Diverse Populations
MUT610 Advanced MT Practicum
MUT614 Grant Writing in Music Therapy
MUT621/622 Advanced MT Internships I, II
MUT630 Advanced Music Skills for Therapy
MUT642 Client Assessment in Music Therapy
MUT652 Research Colloquium
MUT690 Culminating Project in MT

Management and Leadership

MML600 Leadership Foundations
MML603 Managing Organizational Performance
MML618 Research Methods and Data Analytics
MML621 Strategic Management

Note: The College of Graduate Studies reserves the right to change the courses offered, enrollment caps, times, and faculty.

How To Register Online

If you are a current graduate student at Immaculata University, you can register online for **Summer 2019** courses through S.S. IU (Self-Service IU) beginning at **6:00 a.m. on Monday, March 25, 2019**.

Use this copy of the course listing to prepare your schedule and make note of the CRN number provided with each course. Please note that there are some course registrations that must be handled through the Graduate Office. See the "Online Registration Restrictions/Notes" on Page 14.

PREPARING TO REGISTER:

- Go to <http://myiu.immaculata.edu>

Username: First initial of First name + Last Name i.e. jsmith
Password: Birthdate in MMDDYY format i.e. 021589

When logging into MyIU for the first time, you must first click the 'Change Password' link on the MyIU login screen. That will step you through changing your initial password to something new. Also, if you have a common last name, there might be a number after your username (i.e. jsmith2). Additional help is available on the MyIU login page or by calling the Graduate Office.

After you have logged into MyIU, click on the S.S.IU channel (no additional login required)

STUDENT FINANCIAL RESPONSIBILITY AGREEMENT (SFRA):

All students at Immaculata University are required to agree to the Student Financial Responsibility Agreement (SFRA) once each term before registering for courses. The agreement defines the financial terms and conditions associated with course registration and includes the student's responsibility regarding payment of tuition and fees, IU email, electronic billing, late fees, financial holds, financial aid, course add/drop/withdrawal, change of name/address/phone number and debt collection.

To accept the terms of the agreement:

-From the main menu of SSIU, click Student, Student Financial Responsibility Agreement, and select Term. Read the terms and select the Confirm Agreement button. Once this is completed you will be able to move onto Look Up Classes.

LOOK UP CLASSES:

If you want to view the course listing online, follow directions below. The online course schedule is in "real time" and contains the most up-to-date information with regard to remaining seats.

- Click on **Look-up Classes**.
- In the **Search by Term** box, select a registration term from the drop down menu and click on the **Submit** button. This brings up the **Look up Classes** screen. Please note that if you did not accept the terms of the SFRA above, you will be prompted to do so before going any further.
- Using the arrows to scroll up and down in the **Subject** box, click on the desired subject description.
Note: All graduate courses start with Grad-Subject, (i.e. Grad-Core, Grad-EDL, Grad-Psync).
- Click on **Course Search** at the bottom of the screen to return the results of your search. You may then View Sections as appropriate. Use the back arrow key to move back to prior screen.
- Choose the **Advanced Search** feature to refine or expand your results. (you must select at least one Subject – hold the shift key down to select multiple Subjects.)

Please note, closed sections will be indicated with a "C" in the Select column to the left of the CRN. Please call the Graduate Office if you wish to be placed on a wait list.

Once you are satisfied with your course selections, follow these instructions to register:

ADD CLASSES:

Select a section by clicking on the checkbox to the left side of the search results list. Click the **Register** button at the bottom of the screen.

This opens up the **Add or Drop Classes** page. The class is added to your schedule. You can see it in the **Current Schedule** listing. “**Web Registered**” should appear in the Status column.

Classes that cannot be added successfully will appear under **Registration Add Errors**. The status will denote the error. Click on the **Submit Changes** button at the bottom of the screen to clear the errors.

To select alternate courses or sections click on **Class Search** to return to the **Look Up Classes** screen and repeat the process.

Another way to add courses is to **Return to Menu** after you review the courses on **Look Up Classes**.

- Click on **Add or Drop Classes**.
- Enter the CRN’s in the boxes under **Add Classes Worksheet** on the bottom of screen.
- Click **Submit Changes** and the classes will be added to your schedule or you will see Registration Add Errors.

You will be permitted to add classes online for Summer I and Full until May 19, 2019. For Summer II, you will be permitted to add classes online until July 7, 2019. If you need to add a class after these dates, please submit an add/drop form to the Graduate Office for processing.

DROP CLASSES:

- Click on **Add or Drop Classes**.
- Select “**Web Drop**” from the **Action** pull down list to the left of the class CRN.
- Click **Submit Changes** and the course will be removed from your schedule if the date of the transaction is within the Drop period.

You may drop a class online up until the day before classes begin: Summer I and Full - May 19, 2019 and Summer II - July 7, 2019. If you need to drop a class after these dates, please submit the add/drop form to the Graduate Office for processing. If you are dropping all of your courses for a term, you must contact the Graduate Office as you are not permitted to drop your “**last class**” online. We will assist you.

PAYMENT INFORMATION:

Tuition and fees are due in full by **April 26, 2019. To avoid late fees and account holds, please make your payment on time. For additional information regarding billing and payment policies, please refer to inside back cover.**

From main menu: How to make a payment

- Online at S.S. IU: From the main menu click STUDENT, STUDENT ACCOUNT, then STUDENT ACCOUNT CENTER. Select MAKE PAYMENT tab at top. Credit card and check payments are accepted.
- By mail, make check payable to Immaculata University and mail to: Business Office, Villa Maria #14, Immaculata, PA 19345.
- In person at the Business Office located in Room #14 in the terrace level of Villa Maria between the hours of 8:30 am - 4:00 pm.
- Payment drop box is located outside the Business Office doors in Villa Maria.
- Payment questions may be directed to studentaccounts@immaculata.edu or by phone at 610-647-4400, ext. 3174.

PRINT YOUR SCHEDULE:

Now that you are registered, **Return to Menu**, and select **Student Detail Schedule** to view and print your schedule. If you are planning to request a student ID Card this semester, the One Card office requires you bring a copy of your printed schedule showing the courses for which you have registered.

ACCESS MY FINAL GRADE

Final grades must be posted on SSIU in order to be viewed. If your grade is not posted, visit the site periodically after the conclusion of your course. **Student: Student Records: Final Grades: Select a Term and Submit.** Also, the **Graduate Student Course Reimbursement** form is available to view and print from the Student menu. This form summarizes course-related charges and grades by term and can be used for reimbursement.

ONLINE REGISTRATION RESTRICTIONS/NOTES:

Prerequisites:

If you have not completed the appropriate prerequisite for a course, you will get an error. Please contact the Graduate Office for assistance.

Repeats:

Take care not to register for a course which you have already taken. If you are required to repeat a course in order to achieve a higher grade, please contact the Graduate Office for assistance.

Leave of Absence:

If you are on a leave of absence, you will not be able to register. Please notify the Graduate Office that you are planning to return and want to register. We will reactivate you as an Active student which will then allow you to register online or through the Graduate Office.

Enrichment Status:

Students who are studying only as enrichment with a major of Enrichment, are not permitted to register online. Please fill out the registration form provided in this booklet and submit to the Graduate Office for processing.

Independent Projects:

All students studying an independent project must register through the Graduate Office. Please complete and submit the registration form provided in this booklet as well as the "Independent Project" form. Independent Project forms are available in the Graduate Office.

Dissertations:

Doctoral students studying Dissertation I, II, III or continuous, will receive an email with the CRN number for their section of dissertation so that they can register online. If you need dissertation registration assistance, please call 610-647-4400, Ext. 3215.

Doctoral Internships:

Doctoral students on internship will receive their CRN number (s) via email from the Graduate Office. If you need internship registration assistance, please call 610-647-4400, Ext. 3214.

Offsite/Cohort Students:

Offsite sections (CRN's) are not listed in this publication. You will receive registration instructions from the Special Programs Department. However, if you are going to register for a class on campus, you may follow the instructions as noted in this booklet.

Holds:

You will be required to clear any financial or other holds on your account prior to registering online or through the Graduate Office.

If you have any questions about registration, please contact the College of Graduate Studies office at 610-647-4400, Extension 3215. We will be glad to assist you with your registration.

For technical support, please email the Immaculata University Help Desk at helpdesk@immaculata.edu. Please provide your User ID, Name, Contact Information, and a brief description of your question or issue.

IMMACULATA UNIVERSITY
College of Graduate Studies

Expenses and Payment Policies

Tuition, Charges and Fees – 2018-2019

Application Fee (Master’s).....	\$50
Application Fee (Doctoral).....	\$75
Organization Leadership Course Fee.....	\$95
Tuition	
Masters Courses.....	\$710 per credit
Doctoral Ed.D Courses.....	\$955 per credit
Doctoral Psy.D Courses.....	\$990 per credit
Practicum and Internship Fees (per semester)	
Student Teaching.....	\$230
Music Therapy.....	\$50/\$100
Nursing.....	\$110
Nutrition Education.....	\$260
Psychology Field Site.....	\$200
Comprehensive Examination Fee	
Master’s.....	\$75/\$100
Doctoral.....	\$100/\$160
Graduation Fee	\$150
Late Payment Fee.....	\$30
Returned Check Charge.....	\$30

For an inclusive list of charges visit www.immaculata.edu/admissions/graduate/tuition_fees.

STUDENT FINANCIAL RESPONSIBILITY AGREEMENT (SFRA)

All students at Immaculata University are required to agree to the Student Financial Responsibility Agreement once each term before registering for courses. The Agreement is available in the registration area of SSIU (Self-Service IU), accessible through MyIU, and defines the financial terms and conditions associated with course registration. For more information regarding how to accept the SFRA online, refer to page 13.

BILLING AND PAYMENT POLICY

Tuition and fees are due to be paid in full by April 26, 2019. Initial term bill will be generated electronically beginning April 4, 2019. If registering after April 12, 2019, make payment at time of registration. Subsequent monthly billing statements will be available electronically through S.S. IU.

Payments are accepted online and additional information can be found on Page 14 under PAYMENT INFORMATION. To avoid account holds and monthly late fees of \$30 be sure to make your payment on time. All financial aid recipients must ensure their financial aid is available by May 1, 2019.

Once registered, a student assumes financial responsibility for charges (see SFRA). Students with outstanding financial obligations are not permitted to attend class, occupy University Housing, and receive grades, teacher certification transcripts or diplomas. Immaculata reserves the right to assign outstanding balances to collection agencies.

Students who are reimbursed by employers may obtain a course enrollment document that includes course information, grade and cost. This document is available online at SSIU; accessible through MyIU. Immaculata University offers an employer billing option to those who qualify. Information is available at <http://www.immaculata.edu/leadership/BusinessOffice> or through MyIU.

IU INSTALLMENT PAYMENT PLAN

You may choose to enroll in the IU Installment Payment Plan which distributes payment across 3 due dates within the term. Enrollment forms are available online at <http://www.immaculata.edu/leadership/BusinessOffice> or through MyIU. There is a \$25 non-refundable installment plan enrollment fee that is due immediately; this fee is not included as part of the installment payment plan. To avoid account holds and a monthly late fee of \$30, please remit payment at time of enrollment. For your convenience payments are accepted online through Self Service IU (SSIU).

Installment payments due: **April 26, 2019** **May 26, 2019** **June 25, 2019**

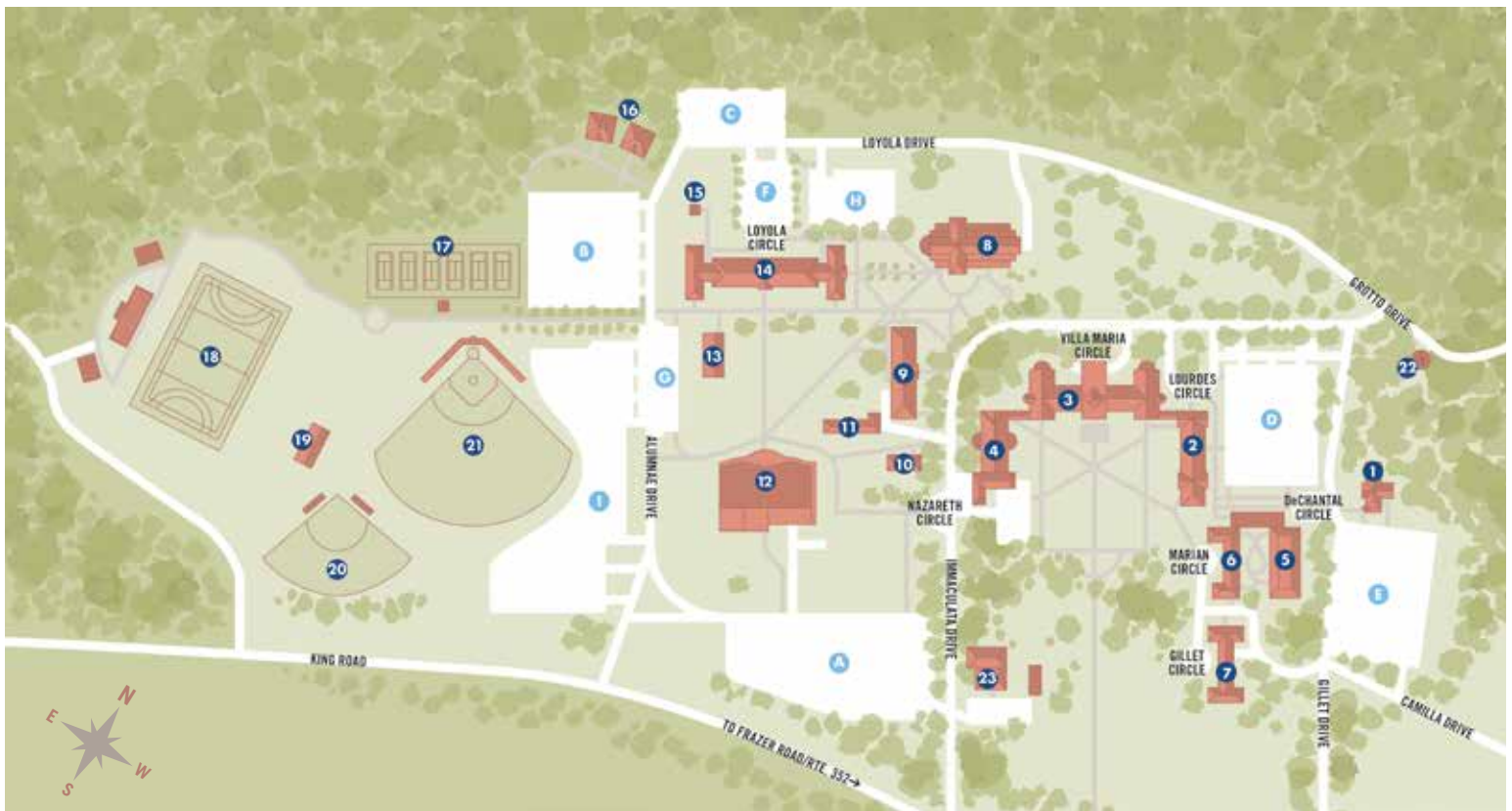

**1145 KING ROAD
IMMACULATA, PA 19345**
USE MALVERN, PA 19355
FOR GPS PURPOSES

PARKING LOTS

- A. Alumnæ Hall General Parking, Freshmen
- B. General Parking Area
- C. General Parking Area
- D. Lourdes Employee Parking Area; administration, faculty, employees and visitors. CLL, graduate and commuter students ONLY may park in this lot between 4 and 11 PM weekdays.
- E. Upper Classmen-Resident Students Parking Area
- F. Faculty/Administration Parking Area
- G. Faculty/Administration Parking Area
- H. General Parking Area; no overnight parking
- I. General Parking Area

**1. Lillian P. Lettiere Center
(Admissions and Financial Aid)**

Post Office
Registrar
Residence Halls
Academic Advisement (Undergrad)

2. **Lourdes Hall**
Campus Safety & Protection
Great Hall
Immaculata Room
Office of Technology Services
(Help Desk)

4. **Nazareth Hall**
Chapel
Dining Hall (Main)
Dining Room (Guest)

3. **Villa Maria Hall**
Blue Room
Business Office
Canon Copy Center
Green Room
Human Resources
Memorial Hall
Music Hall
Pathways to Success

5. **DeChantal Residence Hall**
Campus Ministry
Student Life Offices

6. **Marian Residence Hall**
7. **Gillet Hall**
IHM Faculty Residence

8. **Gabriele Library**
Career Development
Duffy's Cut Museum
Immaculatté Café
Learning Commons
Media Classroom
Writing Center

9. **Good Counsel Hall**
Follett Campus Bookstore
College of Adult Professional Studies
Administrative Offices

10. **Mary A. Bruder Center**
Counseling Services
Student Wellness Center

11. **Faculty Center**

12. **Alumnæ Hall**
Athletic Offices
Athletic Training Facility
Cue and Curtain Office
Fitness Center
Gymnasiums
Pool
Theater

13. **Loyola Modular Structure**

14. **Loyola Hall**
College of Graduate Studies
Administrative Offices
Math Center
POD Market
(Provisions on Demand)

15. **McIntyre Greenhouse**

16. **West Campus Housing**

17. **Tennis Courts**

18. **Draper Walsh Stadium**

19. **Mighty Macs Training Facility**

20. **Softball Field**

21. **Baseball Field**

22. **Lourdes Grotto**

23. **Power House**



**1145 KING ROAD
IMMACULATA, PA 19345**
USE MALVERN, PA 19355
FOR GPS PURPOSES

Directions to Immaculata University *(minutes from Exton, West Chester, and Paoli, PA)*

By Car

Rte 30 Lower Merion/Villanova:

Take Rte 30 W/Lancaster Ave towards Paoli/Exton. Continue on Rte 30 W/Lancaster Ave to Rte 352 S/Sproul Rd. Turn left onto Rte 352 S/Sproul Rd. Follow directions from Rte 352 & 30.

Rte 30 Exton/Downingtown:

Take Rte 30 W/Lancaster Ave towards Philadelphia. Continue on Rte 30 E past Rte 202 to Rte 352 S/Sproul Rd. Turn right onto Rte 352 South/Sproul Rd. Follow directions from Rte 352 & 30.

From West Chester Pike (Rte 3):

Travel east or west to Rte 352; follow Rte 352 N. Turn left at light onto King Road. University is one mile on right.

From King of Prussia:

Take Rte 202 S to Rte 29 Malvern exit (follow Immaculata University sign – 2nd exit); bear right to Rte 29; turn right on Rte 29; at 3rd light, turn right onto Rte 30 W. Go to Rte 352 S, turn left. Follow directions from Rte 352 and Rte 30.

From Philadelphia:

Take Schuylkill Expressway (I-76) West to Rte 202 S towards West Chester. Follow the King of Prussia directions.

Turnpike (I-276) West:

Travel to the Downingtown exit 312; take Rte 100 S to Rte 30/Lancaster Ave.; turn left on Rte 30 E/Lancaster Ave. to Rte 352/Sproul Rd; turn right on Rte 352 S/Sproul Rd; follow directions from Rte 352 & Rte 30.

Turnpike (I-276) East:

Follow the PA Turnpike to the Valley Forge Exit (326). Once past the tolls, follow Rte 202 S towards West Chester. Follow the King of Prussia directions.

From Wilmington & I-95:

Travel north on Rte 202 to the Rte 30/Frazer Exit; turn right on Rte 30 E/Lancaster Ave and continue to Rte 352/Sproul Rd; turn right on Rte 352/Sproul Rd; follow directions from Rte 352 & Rte 30.

From Rte 352 & Rte 30:

Travel south on Rte 352. Proceed under the railroad bridge to the first light which is King Road. Turn right onto King Road. Immaculata is one mile on the right.

By Train, Bus, Taxi

From Center City Philadelphia:

Take SEPTA R5 train west to Paoli. SEPTA bus 133 runs from King of Prussia through Paoli to the University. For taxi service from Paoli, call 610-644-2564.

By Air

Immaculata is approximately a 50-minute drive from Philadelphia International Airport, where limousine service is available to the Paoli/Malvern area. The SEPTA R1 train from the airport connects with the R5 train (Paoli Local).

