

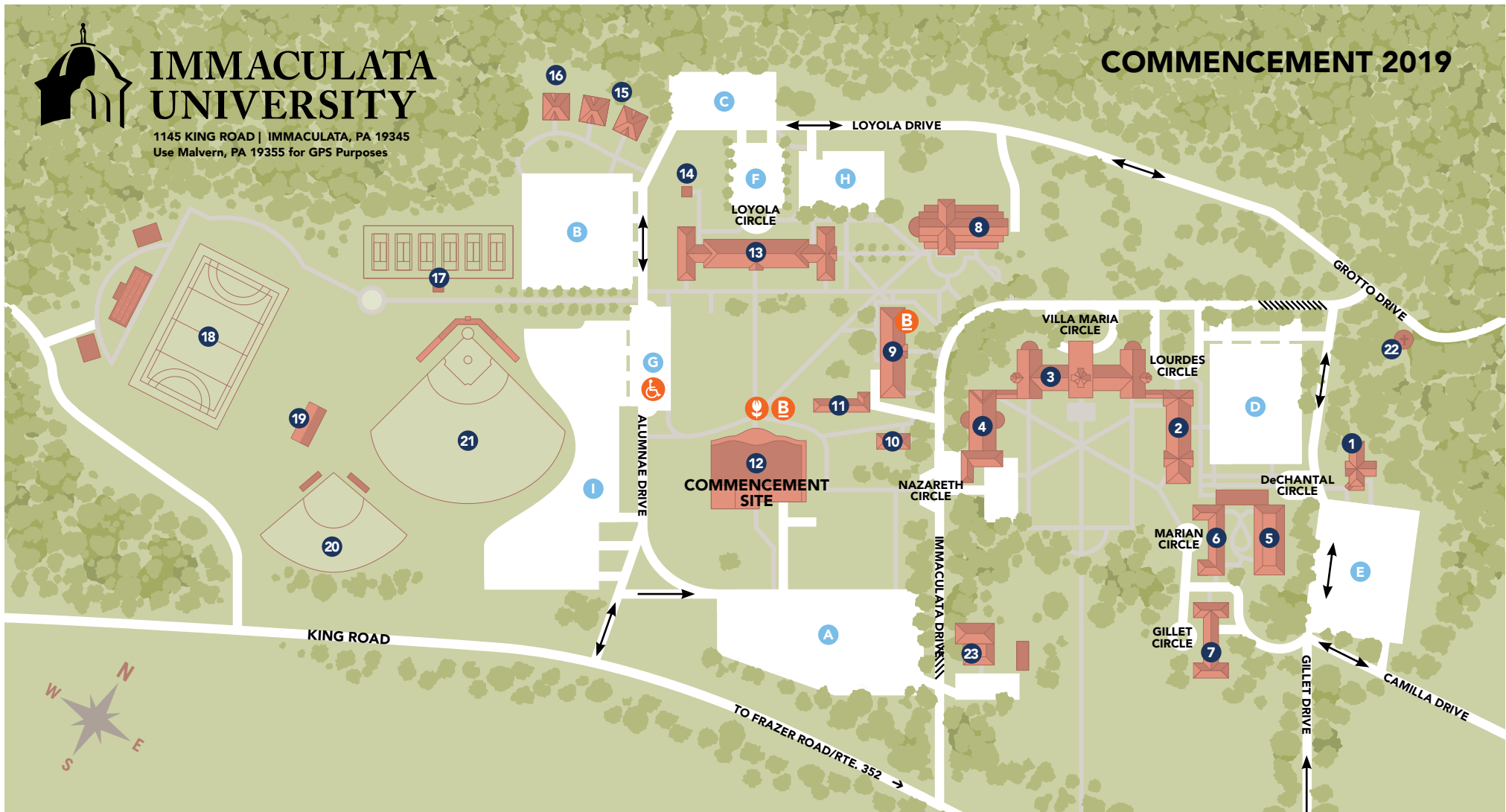

IMMACULATA UNIVERSITY

1145 KING ROAD | IMMACULATA, PA 19345
Use Malvern, PA 19355 for GPS Purposes

COMMENCEMENT 2019



IMMACULATA UNIVERSITY BUILDING KEY

- | | |
|-------------------------------|----------------------------|
| 1. Lillian P. Lettiere Center | 13. Loyola Hall |
| 2. Lourdes Hall | 14. McIntyre Greenhouse |
| 3. Villa Maria Hall | 15. West Campus Housing |
| 4. Nazareth Hall | 16. IHM Student Center |
| 5. DeChantal Residence Hall | 17. Tennis Courts |
| 6. Marian Residence Hall | 18. Draper Walsh Stadium |
| 7. Gillet Hall | 19. Macs Training Facility |
| 8. Gabriele Library | 20. Softball Field |
| 9. Good Counsel Hall | 21. Baseball Field |
| 10. Mary A. Bruder Center | 22. Lourdes Grotto |
| 11. Faculty Center | 23. Power House |
| 12. Alumnae Hall | |

COMMENCEMENT KEY

- Bookstore
- Flowers
- Handicap Drop-Off
- Road Closure

PARKING INFORMATION

Parking Lots: All campus parking lots, except for Lot G, will be open for parking.

Passenger Drop-Off: Parking Lot G on Alumnae Drive

Disability parking: Designated parking spaces may be limited in close proximity to Alumnae Hall. Drivers should be prepared to drop off passengers at the passenger drop-off location prior to parking their vehicle in the nearest available lot.

No parking areas: Parking is not permitted along campus roadways or on grassy areas. Parking on roadways will restrict the smooth flow of traffic. More importantly, parked vehicles may impede the access of emergency vehicles.

ARRIVING AT COMMENCEMENT

Alumnae Drive should be used to access the passenger drop-off location (Lot G) as well as the parking lots closest to Alumnae Hall, the site of the Commencement ceremony.

Immaculata Drive can be used to access Parking Lot A from the east end of the parking lot, but will be closed through campus to Gillet Drive. Gillet Drive can be used to access Parking Lots D and E on the east side of campus.