



COLLEGE OF GRADUATE STUDIES

**COURSE LISTING
FALL 2019**

August 26–December 5, 2019



**IMMACULATA
UNIVERSITY**

CLASS MEETING DATES

Fall 2019

August 26, 2019 – December 5, 2019

<u>Monday</u>	<u>Tuesday</u>	<u>Wednesday</u>	<u>Thursday</u>
August 26	August 27	August 28	August 29
September 2 - OFF	September 3	September 4	September 5
September 9	September 10	September 11	September 12
September 16	September 17	September 18	September 19
September 23	September 24	September 25	September 26
September 30	October 1	October 2	October 3
October 7	October 8	October 9	October 10
October 14	October 15	October 16	October 17
October 21	October 22	October 23	October 24
October 28	October 29	October 30	October 31
November 4	November 5	November 6	November 7
November 11	November 12	November 13	November 14
November 18	November 19	November 20	November 21
November 25	November 26-OFF	November 27-OFF	November 28-OFF
December 2	December 3	December 4	December 5

Note: Certain graduate classes follow an alternate calendar. Please check courses carefully for meeting dates.

Immaculata University is committed to the principle of equal educational opportunity without unlawful discrimination because of an applicant's or student's race, gender, ethnicity, religion, age, national origin, color, disability, marital status, familial status, veteran status, ancestry, genetic characteristics, pregnancy, Or other classifications protected by law or University policy.



**COLLEGE OF
GRADUATE STUDIES**

1145 King Road | Loyola Hall 130
Immaculata, PA 19345
Phone: 610-647-4400 x3211/3212
Fax: 610-993-8850

Dear Students:

We are pleased to invite new, continuing and prospective students to preview the Fall 2019 College of Graduate Studies Course Listing.

Immaculata University offers masters, doctoral, and certification programs in the areas of Education, Psychology, HealthCare and Business. All of our programs are rooted in academic rigor, ethical integrity, and Christian core values and encourage a commitment to lifelong learning and professional excellence. Students are supported by an engaged and professional faculty who create opportunities for growth through teaching-learning relationships, research, and service.

To meet student needs, graduate courses are offered face to face, online and hybrid. The course listing is arranged by department and provides specific details for each course offering. Course descriptions can be found in the Graduate Catalog available on the website at www.immaculata.edu/graduate.

Online registration begins on Monday, July 8 at 6:00 am. Directions for registering online can be found on page 12. The Fall 2019 semester begins on Monday, August 26, 2019.

New and current students needing assistance with registration may contact the Graduate Office at 484-323-3211 or graduate@immaculata.edu.

There is still time for prospective master level students to apply for the Fall semester. Apply online at www.immaculata.edu/gradapply or contact Sandra Rollison, Associate Dean at 484-323-3215 or srollison@immaculata.edu.

Wherever you are in your academic journey we are dedicated to helping you achieve your academic and professional goals!

Sincerely,

Dr. Thomas F. O'Brien
Dean, College of Graduate Studies

**REGISTRATION INFORMATION
FALL 2019**

Not A Current Student?
Interested in Taking A Course?
Call 610-647-4400, Ext. 3224 for Application Information
gradadmission@immaculata.edu

GENERAL INFORMATION:

The Fall 2019 registration process begins with the publication of this listing for graduate course offerings. Please refer to the “Class Meeting Dates” on the inside front cover for specific term dates.

TYPES OF REGISTRATION:

Online Registration: Graduate students may register online using (S.S. IU) - Self-Service Immaculata University. Please refer to Pages 12-14 for step-by-step instructions on “How to Register Online.”

Online registration will open at **6:00 a.m. on Monday, July 8, 2019**. Additionally, paper registrations will be entered by the office staff beginning on Monday, July 8, 2019. Online registrations are processed in “real time” (24/7) and paper registrations are processed during regular business hours in the order that they are received until the class limit has been reached. Wait lists will be managed through the Registrar’s Office. All financial obligations must be met prior to online registration and office registration.

ADVISEMENT:

The Graduate Office staff will submit your course selections to your advisor for review, approval and signature regardless of whether you register online or submit a paper registration.

If you would like to meet with your advisor prior to submitting course selections, please call as soon as possible to schedule an appointment.

DROP/ADD - WITHDRAWAL - REFUND POLICY:

Following the submission of either an official add/drop form or a withdrawal form (after the third session), tuition refunds for semester length courses are made on the following basis:

prior to first class.....	100%	after the third but prior to the fourth class.....	40%
after the first but prior to the second class.....	80%	after the fourth but prior to the fifth class.....	20%
after the second but prior to the third class.....	60%	after the fifth class.....	no refund

Students may add and drop classes online for Fall until August 25, 2019. After this date, you must process registration updates through the Graduate Office.

-Refund policies for 7 week courses can be found at <http://www.immaculata.edu/academics/registrar/refunds>.

-Refunds for special topics and other courses scheduled in special formats will be pro-rated.

COLLEGE OF GRADUATE STUDIES

Fall 2019 Course Schedule

Monday, August 26, 2019 – Thursday, December 5, 2019

CORE/GENERAL PROGRAM SUPPORT COURSES

Dr. Marcia Parris, Associate Dean

CRN	COURSE NO. AND TITLE	CREDIT	DAY/TIME	LOCATION	INSTRUCTOR
90801	GEN 501A Human Development (online)	3	Log into Moodle Th 8/29 by 10:00 pm	Online	Dr. Fran Rassouli
90802	GEN 501B Human Development	3	M 4:30 – 7:10 pm	333 LH	Dr. Suzann Steadman
90803	GEN 502A Methods of Research	3	T 4:30-7:10 pm	333 LH	Dr. William Carr
90804	GEN 502B Methods of Research (online)	3	Log into Moodle Th 8/29 by 10:00 pm	Online	Dr. Kathryn Soeder
90805	GEN 503A Interpersonal Relations	3	Th 5:00 – 9:00 pm (8/29 – 10/17)	333 LH	Bernadette Dougherty, MA
90806	GEN 503B Interpersonal Relations (online)	3	Log into Moodle W 8/28 by 10:00 pm	Online	Dr. Steve Catrambone
90815	GEN 517 Statistical Concepts for Applied Research	3	Sa 10:00 am – 2:00 pm 9/7 & 9/14	3 LH	Dr. Maria Cuddey-Casey

EDUCATIONAL LEADERSHIP

Dr. Karen Miscavage, Director

CRN	COURSE NO. AND TITLE	CREDIT	DAY/TIME	LOCATION	INSTRUCTOR
90679	EDL 591 Modified Student Teaching	3	W 4:15 – 5:30 pm (8/28 – 10/9)	127 LH	Dr. David Brennan
90680	EDL 592 Student Teaching	6	W 4:15 – 5:30 pm	127 LH	Dr. David Brennan
90663	EDL 599 Comprehensive Examination	0	Due Monday, October 7	Online	
90667	EDL 613 Testing and Assessment	3	M 4:30 – 8:30 pm (8/26-10/14)	216 LH	Dr. Joseph Corabi
90688	EDL 614 Instructional Needs of ELL (online 10/15 thru 12/3)	3	Log into Moodle M 10/14 by 10:00 pm	Online	Anjali DelPrato, MA
90671	EDL 620 Curriculum Applications (hybrid)	3	W 4:30 – 8:30 pm FF: 8/28; 9/11, 25; 10/9 Online: 9/4, 18; 10/2	219 LH	Dr. Karen Miscavage
90661	EDL 621 Administration (online 8/29 thru 10/10)	3	Log into Moodle W 8/28 by 10:00 pm	Online	Dr. Margaret Schooling
90673	EDL 625 School Law and the Legal Process (online 10/21 thru 12/2)	3	Log into Moodle SU 10/20 by 10:00 pm	Online	Dr. Christopher Harrington
90666	EDL 629 Introduction to Special Education	3	W 4:30 - 8:30 pm (8/28- 10/9)	221 LH	Dr. Kathleen Nolan
90672	EDL 634 Content Area Reading (online 10/16 thru 12/4)	3	Log into Moodle T 10/15 by 10:00 pm	Online	Dr. Margaret Schooling
90674	EDL 637 Technology in Education (online 10/21 thru 12/2)	3	Log into Moodle SU 10/20 by 10:00 pm	Online	Dr. Christopher Harrington
90668	EDL 643 Special Education for School Leaders (online 8/29 thru 10/10)	3	Log into Moodle W 8/28 by 10:00 pm	Online	Dr. Patricia Madeira
90675	EDL 651 Procedures/Processes in Special Education (hybrid)	3	W 4:30-8:30 pm FF: 10/16, 30; 11/13; 12/4 Online: 10/23; 11/6, 20	219 LH	Dr. Karen Miscavage

90710	EDL 654	Foundations of Integrative STEM Education (online 10/16-12/4)	3	Log into Moodle T 10/15 by 10:00 pm	Online	Staff
90670	EDL 660	Instructional Strategies for Standards Aligned Curriculum in Literacy (online 8/28 thru 10/9)	3	Log into Moodle T 8/27 by 10:00 pm	Online	Dr. Grace Cisek
90676	EDL 664	Literacy Assessment and Intervention (online 10/16 thru 12/4)	3	Log into Moodle T 10/15 by 10:00 pm	Online	Dr. Grace Cisek
90696	EDL 690	Principal Practicum Experience (online)	3	T 6:00 – 8:30 pm one class meeting 8/27	220 LH	Dr. Joseph Corabi
90700	EDL 693	Supervisor Internship (online)	3	T 6:00- 8:30 pm one class meeting 8/27	220 LH	Dr. Joseph Corabi

NOTE: **FBI, ACT 34, ACT 151 Clearances Required** for all sections of the following courses:
EDL 591 & EDL 592-Student Teaching, EDL 690-Principal Practicum Experience, EDL 693-Supervisor Internship and EDL 789-Clinical Experience

DOCTOR OF EDUCATION-K-12-LEADERSHIP

Sr. Carol Anne Couchara, Director

CRN	COURSE NO. AND TITLE	CREDIT	DAY/TIME	LOCATION	INSTRUCTOR
90681	EDL 720 Orientation to Doctoral Research	3	M 5:00 – 9:00 pm 8/26 thru 10/14	220 LH	Dr. Margaret Schooling
90682	EDL 725 Communication Theory and Practice	3	Th 5:00 – 9:00 pm 8/29 thru 10/10	216 LH	Dr. Marc Bertrando
90683	EDL 727 Pennsylvania School Code & School Board Policies	3	Th 5:00 – 9:00 pm 10/17 thru 12/5	216 LH	Dr. Marc Bertrando
90684	EDL 728 Curriculum Theory and Evaluation	3	W 5:00 – 9:00 pm 8/28 thru 10/9	216 LH	Dr. Joseph Corabi
90685	EDL 729 Curriculum Management	3	W 5:00 – 9:00 pm 10/16 – 12/4	216 LH	Dr. Margaret Schooling
90701	EDL 789 Clinical Experience (online)	3	T 6:00 – 8:30 pm one class meeting 8/27	220 LH	Dr. Joseph Corabi
90800	EDL 797 Comprehensive Examination	0			Dr. Melissa Reed
	EDL 798 Dissertation I *	3	By arrangement with Dissertation Chair		
	EDL 799 Dissertation II *	3	By arrangement with Dissertation Chair		
	EDL 800 Dissertation III*	3	By arrangement with Dissertation Chair		
	EDL 000 Dissertation Continuation*	0	Open only to students having completed EDL 798, 799 & 800. Fee equivalent to one doctoral credit: \$955 (1 st enrollment) Fee equivalent to three doctoral credits: \$2,865 (subsequent enrollment)		

*Dissertation students will receive their CRN number via Immaculata email. Registration questions may be directed to ext. 3215.

DOCTOR OF EDUCATION-HIGHER EDUCATION

Sr. Ann Heath, Director

CRN	COURSE NO. AND TITLE	CREDIT	DAY/TIME	LOCATION	INSTRUCTOR
90763	HED 702 Methods of Research (hybrid)	3	Th 4:30 – 7:10 pm	102 LH	Dr. Marcia Parris
90765	HED 704 Qualitative and Mixed Methods Research Design (hybrid)	3	Th 4:30 – 7:10 pm	103 LH	Dr. Christine Cavanaugh Dr. John Cavanaugh
90764	HED 725 Finance & Strategic Planning (hybrid)	3	Th 7:20 – 10:00 pm	102 LH	Dr. David Parkyn
90766	HED 765 Current Issues in Nursing Education (hybrid)	3	Th 7:20 – 10:00 pm	103 LH	Staff
	HED 798 Dissertation I *	3	By arrangement with Dissertation Chair		
	HED 799 Dissertation II *	3	By arrangement with Dissertation Chair		
	HED 800 Dissertation III*	3	By arrangement with Dissertation Chair		

HED 000 Dissertation Continuation*

0

Open only to students having completed HED 798, 799 & 800.

Fee equivalent to one doctoral credit: \$955 (1st enrollment)

Fee equivalent to three doctoral credits: \$2,865 (subsequent enrollment)

*Dissertation students will receive their CRN number via Immaculata email. Registration questions may be directed to ext. 3215.

HEALTHCARE MANAGEMENT***Dr. Anne Marie McCauley, Director***

CRN	COURSE NO. AND TITLE	CREDIT	DAY/TIME	LOCATION	INSTRUCTOR
90761	MHCM 604 Aging and Long Term Care Management (8/26/19 – 10/14/19)	3	Log into Moodle on M 8/26 by 10:00 pm	Online	Dr. Anne Marie McCauley
90762	MHCM 606 Resources, Recruitment & Retention in Health Care (10/21/19 – 12/2/19)	3	Log into Moodle on M 10/15 by 10:00 pm	Online	Dr. Anne Marie McCauley

MANAGEMENT AND LEADERSHIP

CRN	COURSE NO. AND TITLE	CREDIT	DAY/TIME	LOCATION	INSTRUCTOR
90712	MML 600 Leadership Foundations (hybrid)	3	T 6:00-10:00 pm 8/27; 9/10, 24; 10/8, 22; 11/5, 19	102 LH	Staff
90713	MML 603 Managing Organizational Effectiveness (hybrid)	3	T 6:00-10:00 pm 9/3, 17; 10/1, 15, 29; 11/12, 26	102 LH	Staff
90714	MML 618 Research Methods & Data Analytics	3	W 6:00-10:00 pm 8/28; 9/11, 25; 10/9, 23; 11/6, 20; 12/4	102 LH	Staff
90715	MML 621 Strategic Management	3	W 6:00-10:00 pm 9/4, 18; 10/2, 16, 30; 11/13; 12/4	102 LH	Staff

NOTE: Pre-course assignments will be posted on Moodle at least one week prior to course start date. In addition to campus meetings, courses delivered utilizing MOODLE.

MUSIC THERAPY***Corey Olver, MA, MT-BC, LPC, Director***

CRN	COURSE NO. AND TITLE	CREDIT	DAY/TIME	LOCATION	INSTRUCTOR
90749	MUT 500 Theoretical Orientation to Music Therapy	3	Th 4:30 – 7:10 pm	208 VM	Corey Olver, MA, MT-BA
90665	MUT 512 Clinical Training I - Integrating Theory & Practice	1	T 5:00-6:00 pm	208 VM	Daniel Benonis, MA, MT-BC
90687	MUT 513 Clinical Training II - Integrating Theory & Practice	1	T 5:00-6:00 pm	208 VM	Daniel Benonis, MA, MT-BC
90689	MUT 514 Clinical Training III - Integrating Theory & Practice	1	T 5:00-6:00 pm	208 VM	Daniel Benonis, MA, MT-BC
PART-TIME:					
90690	MUT 521 Graduate Internship I	2	T 6:30-7:30 pm	Conference call	Daniel Benonis, MA, MT-BC
90691	MUT 522 Graduate Internship II	2	T 6:30-7:30 pm	Conference call	Daniel Benonis, MA, MT-BC
90692	MUT 523 Graduate Internship III	2	T 6:30-7:30 pm	Conference call	Daniel Benonis, MA, MT-BC
FULL-TIME:					
90693	MUT 524 Graduate Internship I	2	T 6:30-7:30 pm	Conference call	Daniel Benonis, MA, MT-BC
90694	MUT 525 Graduate Internship II	2	T 6:30-7:30 pm	Conference call	Daniel Benonis, MA, MT-BC

Notes: -Seminars include both on-campus and conference call meetings. Additional meetings may be arranged.
-Schedule and location of on-site clinical training to be arranged. Contact Corey Olver at colver@immaculata.edu. Please register through SSIU.

90695	MUT 530 Music Skills for Therapy – Piano	1	By arrangement		Laurie Schrecengost, MA
90697	MUT 532 Music Skills for Therapy – Guitar	1	By arrangement		Dr. Bryan Muller
90698	MUT 534 Music Skills for Therapy - Voice	1	By arrangement		Erika Maguire, MA

Please discuss individual music skills requirements with Corey Olver prior to registration: colver@immaculata.edu.

90664	MUT 599 Comprehensive Examination	0			Return no later than Monday, October 7 to the Graduate Office.
-------	-----------------------------------	---	--	--	--

90753	MUT 606	Songs in Psychotherapy	2	Sa, 9/22; 9:00 am – 6:00 pm Sa/Su, 11/16, 17: 9:00 am – 6:00 pm	208 VM	Staff
90752	MUT 609	Music Therapy Practice with Diverse Populations	2	Sa, 9/7 9:00 am – 6:00 pm Sa/Su, 10/19, 20: 9:00 am – 6:00 pm	208 VM	Corey Olver, MA, MT-BA
90702	MUT 610	Advanced Music Therapy Practicum	1	Th 7:30-8:30 pm		Conference call
90703	MUT 621	Advanced Music Therapy Internship I	1	Th 7:30-8:30 pm		Conference call
90704	MUT 622	Advanced Music Therapy Internship II	1	Th 7:30-8:30 pm		Conference call
* Students scheduled for MUT 610, 621, 622 will participate in a weekly supervision conference call and periodic on-campus meetings. Please contact Corey Olver at colver@immaculata.edu for details.						
90699	MUT 630	Advanced Music Skills for Therapy	1	To be arranged through advisement. Please contact Corey Olver at colver@immaculata.edu .		
90751	MUT 642	Client Assessment in Music Therapy	2	Sa, 9/21 9:00 am – 6:00 pm Sa/Su, 11/2, 3: 9:00 am – 6:00 pm	208 VM	Timothy Honig, MMT, MT-BC
90756	MUT 652A	Research Colloquium	1	To be arranged through advisement.		Corey Olver, MA, MT-BC
90757	MUT 652B	Research Colloquium	1	To be arranged through advisement.		Daniel Benonis, MA, MT-BC
90705	MUT 690A	Culminating Project in Music Therapy	3	To be arranged through advisement.		Corey Olver, MA, MT-BC
90754	MUT 690B	Culminating Project in Music Therapy	3	To be arranged through advisement.		Daniel Benonis, MA, MT-BC

NUTRITION EDUCATION

Dr. Qian Jia, Director

CRN	COURSE NO. AND TITLE	CREDIT	DAY/TIME	LOCATION	INSTRUCTOR
90799	NED511 Special Topics in Nutrition: Healthcare Ethics (8/26- 10/15)	1	Log into Moodle on M 8/26 by 10:00 pm	Online	Danielle Kronmuller, MA, RD, LDN
This course will provide an introductory review of healthcare ethics and will supply students with a foundational knowledge to critically think through ethical dilemmas and develop practical approaches to improve care. Topics will include contemporary medical ethics, introduction to end-of-life dilemmas, organizational ethics, healthcare professionals' legal and ethical issues, current events in ethical situations, cultural ethics, and ethics of patient abuse, patient rights, and healthcare professional responsibilities.					
90792	NED 644 Nutrition in the Life Cycle	3	Log into Moodle on M 8/26 by 10:00 pm	Online	Judith Khanuja, MPH
90793	NED 645 Medical Nutrition Therapy I	3	M 7:20 – 10:00 pm	116 LH	Kristen Dwinells, MA, RD, LDN, CNSC
90794	NED 647 Applied Nutrition & Metabolism	3	Log into Moodle on M 8/26 by 10:00 pm	Online	Dr. Qian Jia
90795	NED 659 Preparation for Internship	3	By arrangement with Danielle Kronmuller		
90796	NED 662 Internship Experience in Nutrition I	3	By arrangement with Danielle Kronmuller		
90797	NED 680 Principles of Nutrition Education	3	Log into Moodle on M 8/26 by 10:00 pm	Online	Dr. Cecile Adkins
90798	NED 691 Nutrition Education Capstone	3	Log into Moodle on M 8/26 by 10:00 pm	Online	Dr. Qian Jia

NURSING

Dr. Pamela Hudson, Director

CRN	COURSE NO. AND TITLE	CREDIT	DAY/TIME	LOCATION	INSTRUCTOR
90760	NURS 621 Role Development for Advanced Nursing	3	W 5:00 – 9:00 pm 8/28; 9/4, 18; 10/2, 23, 30; 11/13, 20	2 LH	Dr. Susan Norris
90759	NURS 690 MSN Capstone (75 guided fieldwork hours)	3	W 5:00-9:00 pm 8/28; 9/4, 18; 10/16; 11/6, 20; 12/11	14 LH	Dr. Maria Toth

**CLINICAL MENTAL HEALTH COUNSELING
SCHOOL PSYCHOLOGY**

**Dr. Tracy Stinchfield, Director
Dr. Marie McGrath, Director**

CRN	COURSE NO. AND TITLE	CREDIT	DAY/TIME	LOCATION	INSTRUCTOR
90788	PSYC511A Topics in Psychology: Mindfulness	1	Fr 9/13 4:00-9:00 Sa 9/14 8:00-5:00	123 LH	Cynthia Flores, MA

This course will explore the physiological and psychological benefits of mindfulness, current empirical studies, personal and professional ways of integrating mindfulness, and experiential practice.

90789	PSYC 511B Topics in Psychology: Dual Diagnosis in the Treatment of Addiction	1	Fr 9/27 4:00-9:00 Sa 9/28 8:00-5:00	123 LH	Jane Brown, MA
-------	---	---	--	--------	----------------

This course will explore the major psychiatric disorders often used to define dual diagnosis, discuss reasons for its prevalence, examine preferred treatments as well as medications used in treatment of the dually diagnosed patient. Finally, techniques used in treatment of dually diagnosed patients will be demonstrated.

90790	PSYC 511C Topics in Psychology: Self-Injurious Behavior in Children & Adolescents	1	Fr 10/11 4:00 – 9:00 Sa 10/12 8:00 – 5:00	123 LH	Dr. Jane Thompson
-------	--	---	--	--------	-------------------

This course will focus on the special topic of self-harm in children and adolescents. By taking this course, the student will be able to identify various types of self-injurious behaviors and the reasons why our patients/clients engage in these behaviors. The student will develop an understanding of how self-harm differs from suicide attempts and how to utilize safety protocols in patients who self-harm. Students will gain a basic understanding of the neurobiological differences in children and adolescents that impact impulse control and increase risk taking behaviors that lead to self-harm. Through the use of case studies and journal articles, the class will identify various populations that are vulnerable to self-harm and the ways body image issues, engagement in substance abuse, and other at risk behaviors intermingle and manifest in this population.

90787	PSYC 511D Topics in Psychology: The Psychology and Spirituality of the 12-Step Program	3	Th 7:20-10:00 pm	123 LH	Jennifer Urbine, MA
-------	--	---	------------------	--------	---------------------

This course will examine each of the steps, explore the spiritual nature of the 12-step philosophy, and translate each of the steps into psychological terms. Finally, practical ways to use the 12-step program in counseling clients with addictions will be demonstrated and practiced.

90648	PSYC 607 Treatment of Children and Adolescents	3	M 7:20 – 10:00 pm	121 LH	Dr. Kristy Brumfield
90662	COUN 599 Comprehensive Examination	0	Return no later than Monday, October 7 to the Graduate Office.		
90641	COUN 600 Research & Program Evaluation	3	Th 4:30 – 7:10 pm	116 LH	Dr. David Hunt
90642	COUN 601A Counseling Skills & Techniques	3	W 4:30 – 7:10 pm	2 GC	Dr. Tracy Stinchfield
90643	COUN 601B Counseling Skills & Techniques	3	W 4:30 – 7:10 pm	4 GC	Dr. Rachel Vannatta
90644	COUN 602A Theories of Counseling	3	M 7:20 – 10:00 pm	2 GC	Dr. Deneen Miller
90645	COUN 602B Theories of Counseling	3	M 7:20 – 10:00 pm	4 GC	Dr. Rachel Vannatta
90646	COUN 604 Group Process	3	M 4:30 – 7:10 pm	4 GC	Jane Brown, MA
90647	COUN 606 Family Counseling	3	T 4:30 - 7:10 pm	123 LH	Dr. David Martinson
90649	COUN 608 Psychopathology	3	Th 4:30 – 7:10 pm	4 GC	Shelby Krupka, MA
90650	COUN 609 Career and Vocational Counseling	3	W 4:30 – 7:10 pm	121 LH	Dr. David Hunt
90651	COUN 614 Substance Abuse Education and Counseling	3	Th 4:30-7:10 pm	2 GC	Dr. Deneen Miller
90652	COUN 618 Professional Orientation and Ethical Issues	3	M 7:20 – 10:00 pm	123 LH	Abby Connor, MA
90653	COUN 630 Crisis Intervention and Trauma	3	W 4:30-7:10 pm	123 LH	Dr. David Martinson
90654	COUN 640 Diversity Counseling	3	T 4:30-7:10 pm	121 LH	Dr. Kristy Brumfield
90655	COUN 641 Assessment for Counselors	3	T 7:20-10:00 pm	121 LH	Staff

Clinical Mental Health Counseling:

90656	COUN 691 Practicum in Clinical Mental Health Counseling	3	M 4:30-7:10 pm	TBA	Seminar Faculty*
90657	COUN 692 Internship I in Clinical Mental Health Counseling	3	M 4:30-7:10 pm	TBA	Seminar Faculty*
90658	COUN 693 Internship II in Clinical Mental Health Counseling	3	M 4:30-7:10 pm	TBA	Seminar Faculty*

* Section assignments will be emailed to your IU email address two weeks prior to start of class.

School Psychology and School Counseling:

90785 PSYC 680 Seminar I: School Psychology Internship 3 T 4:30-7:10 pm 2 GC Staff

PSYCHOLOGY PRACTICUM/INTERNSHIP PAPERWORK:

The deadline for practicum paperwork to be submitted is as follows:

Summer Term: January 20 Fall Term: June 1 Spring Term: September 10

Students can access practicum information by logging into MyIU and accessing Moodle.

DOCTOR OF CLINICAL PSYCHOLOGY

Dr. Jed Yalof, ABPP, Chair

CRN	COURSE NO. AND TITLE	CREDIT	DAY/TIME	LOCATION	INSTRUCTOR
90716	COUN 601C Counseling Skills & Techniques (PsyD students only)	3	W 4:30 – 7:10 pm	116 LH	Dr. Jillian Threadgill
90717	PSYC 608 Psychopathology (PsyD students only)	3	Th 4:30 – 7:10 pm	118 LH	Sr. Monica Acri
90741	PSYC 698 Professional Development Series *	0	Th 3:00-4:00 pm 9/19; 10/17; 11/14	18 LH	Staff
*Required for all first year PsyD students.					
90720	PSYC 701A Cognitive & Affective Bases of Behavior	3	M 4:30 – 7:10 pm	118 LH	Staff
90721	PSYC 701B Cognitive & Affective Bases of Behavior	3	M 7:20 – 10:00 pm	118 LH	Staff
90718	PSYC 703A Tests and Measurements (MA admits only)	3	T 7:20 – 10:00 pm	118 LH	Dr. Ashley Higgins
90719	PSYC 703B Tests and Measurements (BA admits only)	3	W 7:20 – 10:00 pm	118 LH	Dr. Ashley Higgins
90722	PSYC 706A Research & Statistics I	3	M 4:30 – 7:10 pm	3 LH	Dr. Marie McGrath
90723	PSYC 706B Research & Statistics I	3	T 7:20 – 10:00 pm	3 LH	Dr. Marie McGrath
90724	PSYC 706C Research & Statistics I	3	T 7:20 – 10:00 pm	117 LH	Staff
90726	PSYC 708 Advanced Psychopathology	3	T 4:30 – 7:10 pm	4 GC	Dr. Janet Etzi
90727	PSYC 711A Psychoanalytic Theories and Therapies	3	M 4:30-7:10 pm	116 LH	Staff
90728	PSYC 711B Psychoanalytic Theories and Therapies	3	W 4:30-7:10 pm	120 LH	Dr. Jed Yalof
90729	PSYC 712A Client-Centered & Relationship Theories and Therapies	3	Th 7:20-10:00 pm	118 LH	Dr. Francien Richardson
90732	PSYC 712B Client-Centered & Relationship Theories and Therapies	3	Th 7:20-10:00 pm	116 LH	Staff
90731	PSYC 729A Assessment II: Personality	3	Th 4:30-7:10 pm	121 LH	Dr. Julie Keveaney
90730	PSYC 729B Assessment II: Personality	3	Th 4:30-7:10 pm	123 LH	Sr. Donna Kelley

Practicum/Seminar:

90735	PSYC 714A Practicum & Seminar I	3	W 4:30 – 7:10 pm	TBA	Seminar Faculty
90736	PSYC 714B Practicum & Seminar I	3	Th 4:30 – 7:10 pm	TBA	Seminar Faculty
90739	PSYC 717A Practicum & Seminar IV	3	W 4:30 – 7:10 pm	TBA	Seminar Faculty
90740	PSYC 717B Practicum & Seminar IV	3	Th 4:30 – 7:10 pm	TBA	Seminar Faculty
90742	PSYC 726A Practicum & Seminar VII	3	W 4:30 – 7:10 pm	TBA	Seminar Faculty

90743	PSYC 726B	Practicum & Seminar VII	3	Th 4:30 – 7:10 pm	TBA	Seminar Faculty
-------	-----------	-------------------------	---	-------------------	-----	-----------------

*Section assignments will be emailed two weeks prior to start of class.

Internship:

PSYC786	Internship in Clinical Psychology I *	1.5	By arrangement with Dr. Catrina Vitagliano
---------	---------------------------------------	-----	--

PSYC787	Internship in Clinical Psychology II *	1.5	By arrangement with Dr. Catrina Vitagliano
---------	--	-----	--

PSYC788	Internship in Clinical Psychology III *	1.5	By arrangement with Dr. Catrina Vitagliano
---------	---	-----	--

*Internship students will receive their CRN number via Immaculata email. Registration questions may be directed to ext. 3214.

Dissertation:

90733	PSYC 790A	Dissertation Research Seminar	3	M 4:30 – 7:10 pm	219 LH	Dr. Maria Cuddy-Casey
-------	-----------	-------------------------------	---	------------------	--------	-----------------------

90734	PSYC 790B	Dissertation Research Seminar	3	W 7:20 – 10:00 pm	120 LH	Dr. Jed Yalof
-------	-----------	-------------------------------	---	-------------------	--------	---------------

PSYC 800	Doctoral Dissertation III *	3	By arrangement with Dissertation Chair
----------	-----------------------------	---	--

PSYC 000	Dissertation Continuation *	0	Open only to students having completed PSYC 798, 799 & 800. Fee equivalent to one doctoral credit: \$990 (1 st enrollment) Fee equivalent to three doctoral credits: \$2,970 (subsequent enrollment)
----------	-----------------------------	---	---

*Dissertation students will receive their CRN number via Immaculata email. Registration questions may be directed to ext. 3215.

NOTES: The University reserves the right to change the courses offered, enrollment caps, times, and faculty. All classes have limited enrollment. You are encouraged to register early.

The College of Graduate Studies supports and encourages the use of technology as a part of the learning process.

College of Graduate Studies

Projected Spring 2020 Course Offerings

January 21, 2020 – May 11, 2020

Core Curriculum

GEN501 Human Development
GEN502 Methods of Research
GEN503 Interpersonal Relations

Clinical Mental Health Counseling

School Psychology

COUN600 Research & Program Evaluation
COUN601 Counseling Skills & Techniques
COUN602 Theories of Counseling
COUN604 Group Process
COUN606 Family Counseling
COUN608 Psychopathology
COUN609 Career and Vocational Counseling
COUN614 Substance Abuse Education and Counseling
COUN618 Professional Orientation and Ethical Issues
COUN630 Crisis Intervention and Trauma
COUN640 Diversity Counseling
COUN641 Assessment for Counselors
COUN691,692,693 Practicum, Internship I, II in CMHC
PSYC607 Treatment of Children & Adolescents
PSYC654 Princ of Acad Assmt, Instr & Intervention
PSYC681 Seminar II: School Psychology Internship
PSYC694 Internship in School Counseling (Pre-K-12)

Doctor of Psychology – Clinical

PSYC698 Professional Development Series
PSYC700 Biological Bases of Behavior
PSYC707 Research & Statistics II
PSYC710 Cognitive & Behavioral Theories & Therapies
PSYC715 Practicum & Seminar II
PSYC721 Psychology of Human Diversity
PSYC724 Practicum & Seminar V
PSYC728 Cognitive Clinical Assessment
PSYC730 Assessment IV: Advanced Skills
PSYC745 Social Psychology
PSYC766 Advanced Neuropsychology
PSYC768 Forensic Psychology
PSYC 798 Dissertation I
PSYC800 Dissertation III
Clinical Internships

Doctor of Education – Higher Education

HED705 Introduction to Higher Education
HED721 Diversity & Multiculturalism in Higher Education
HED766 Professional Ethics and Doctoral Competencies
HED790 Dissertation Research Seminar
HED 797 Comprehensive Examination
HED798-799-800 Dissertation I, II or III
HED820 Applied Field Experience

Doctor of Education – K-12

EDL702 Methods of Doctoral Research
EDL721 School Leadership in Teaching & Learning
EDL722 Personnel Management & Labor Relations
EDL731 Advanced Supervision
EDL732 Staff Development
EDL734 Dissertation Research Seminar
EDL789 Clinical Experience
EDL798-799-800 Dissertation I, II or III

Educational Leadership

EDL591 Modified Student teaching
EDL592 Student Teaching
EDL614 Instructional Needs of ELL
EDL615 Contemporary Professional Ethics
EDL617 Foundations of Education and Learning
EDL622 Curriculum and Instruction
EDL623 Supervision
EDL626 School Community Relations
EDL630 Strategies for the Classroom Teacher
EDL643 Special Ed for School Leaders
EDL644 Language Arts Methods
EDL652 Strategies High Incidence Disabilities
EDL655 Curr., Inst., and Assess. in STEM Education
EDL690/693 Principal Practicum/Supervisor Internship

HealthCare Management

MHCM608 Financial Management in Healthcare
MHCM 616 Healthcare Strategic Planning & Marketing

Management and Leadership

MML600 Leadership Foundations
MML603 Managing Organizational Performance
MML606 Leading High Performing Teams
MML609 Economic Foundations of Finance
MML624 Innovation and Project Management
MML627 Leading Change Capstone

Music Therapy

MUT502 Theories & Process in MT Practice
MUT512, 513, 514 Clin Training: Integr Theor & Pract
MUT521, 522, 523 Graduate Internships I, II, III
MUT524, 525 Graduate Internships I, II
MUT530, 532, 534 Music Skills for Therapy
MUT608 Ethical & Prof Orientation in Music Therapy
MUT610 Advanced Music Therapy Practicum
MUT621, 622 Adv Music Therapy Internships I, II
MUT630 Advanced Music Skills for Therapy
MUT 643 Integration of Verbal Counseling and Music Therapy Skills
MUT646 Music Therapy Research
MUT652 Research Colloquium
MUT690 Culminating Project in MT

Nutrition

NED511 Special Topics in Nutrition
NED653 Health Counseling
NED655 Medical Nutrition Therapy II
NED663 Internship Experience in Nutrition II
NED680 Principles of Nutrition Education
NED691 Nutrition Capstone

Nursing

NURS655 Nursing Research

(The College of Graduate Studies reserves the right to change the courses offered, enrollment caps, times, and faculty.)

How To Register Online

If you are a current graduate student at Immaculata University, you can register online for **Fall 2019** courses through S.S. IU (Self-Service IU) beginning at **6:00 a.m.** on **Monday, July 8, 2019**.

Use this copy of the course listing to prepare your schedule and make note of the CRN number provided with each course. Please note that there are some course registrations that must be handled through the Graduate Office. See the “Online Registration Restrictions/Notes” on Page 14.

PREPARING TO REGISTER: Go to myiu.immaculata.edu

Username: First initial of First name + Last Name i.e. jsmith
Password: Birthdate in MMDDYY format i.e. 021589

When logging into MyIU for the first time, you must first click the ‘Change Password’ link on the MyIU login screen. That will step you through changing your initial password to something new. Also, if you have a common last name, there might be a number after your username (i.e. jsmith2). Additional help is available on the MyIU login page or by calling the Graduate Office.

After you have logged into MyIU, click on the S.S.IU channel (no additional login required)

STUDENT FINANCIAL RESPONSIBILITY AGREEMENT (SFRA):

All students at Immaculata University are required to agree to the Student Financial Responsibility Agreement (SFRA) once each term before registering for courses. The agreement defines the financial terms and conditions associated with course registration and includes the student’s responsibility regarding payment of tuition and fees, IU email, electronic billing, late fees, financial holds, financial aid, course add/drop/withdrawal, change of name/address/phone number and debt collection.

To accept the terms of the agreement:

From the main menu of SSIU, click Student, Student Financial Responsibility Agreement, and select Term. Read the terms and select the Confirm Agreement button. Once this is completed you will be able to move onto Look Up Classes.

LOOK UP CLASSES:

If you want to view the course listing online, follow directions below. The online course schedule is in “real time” and contains the most up-to-date information with regard to remaining seats.

- Click on **Look-up Classes**.
- In the **Search by Term** box, select a registration term from the drop down menu and click on the **Submit** button. This brings up the **Look up Classes** screen. Please note that if you did not accept the terms of the SFRA above, you will be prompted to do so before going any further.
- Using the arrows to scroll up and down in the **Subject** box, click on the desired subject description.
Note: All graduate courses start with Grad-Subject, (i.e. Grad-Core, Grad-EDL, Grad-Psync).
- Click on **Course Search** at the bottom of the screen to return the results of your search. You may then View Sections as appropriate. Use the back arrow key to move back to prior screen.
- Choose the **Advanced Search** feature to refine or expand your results. (you must select at least one Subject – hold the shift key down to select multiple Subjects.)

Please note, closed sections will be indicated with a “C” in the Select column to the left of the CRN. Please call the Registrar’s Office if you wish to be placed on a wait list.

Once you are satisfied with your course selections, follow these instructions to register:

ADD CLASSES:

- 12 Select a section by clicking on the checkbox to the left side of the search results list. Click the **Register** button at the bottom of the screen.

This opens up the **Add or Drop Classes** page. The class is added to your schedule. You can see it in the **Current Schedule** listing. “**Web Registered**” should appear in the Status column.

Classes that cannot be added successfully will appear under **Registration Add Errors**. The status will denote the error. Click on the **Submit Changes** button at the bottom of the screen to clear the errors.

To select alternate courses or sections click on **Class Search** to return to the **Look Up Classes** screen and repeat the process.

Another way to add courses is to **Return to Menu** after you review the courses on **Look Up Classes**.

- Click on **Add or Drop Classes**.
- Enter the CRN’s in the boxes under **Add Classes Worksheet** on the bottom of screen.
- Click **Submit Changes** and the classes will be added to your schedule or you will see Registration Add Errors.

You will be permitted to add classes online for Fall until August 25, 2019. If you need to add a class after this dates, please submit an add/drop form to the Graduate Office for processing.

DROP CLASSES:

- Click on **Add or Drop Classes**.
- Select “**Web Drop**” from the **Action** pull down list to the left of the class CRN.
- Click **Submit Changes** and the course will be removed from your schedule if the date of the transaction is within the Drop period.

You may drop a class online up until the day before classes begin, August 25, 2019. If you need to drop a class after this date, please submit the add/drop form to the Graduate Office for processing. If you are dropping all of your courses for a term, you must contact the Graduate Office as you are not permitted to drop your “**last class**” online. We will assist you.

PAYMENT INFORMATION:

Tuition and fees are due in full by August 1, 2019. To avoid late fees and account holds, please make your payment on time. For additional information regarding billing and payment policies, please refer to page 15.

From main menu: How to make a payment

- Online at S.S. IU: From the main menu click STUDENT, STUDENT ACCOUNT, then STUDENT ACCOUNT CENTER. Select MAKE PAYMENT tab at top. Credit card and check payments are accepted.
- By mail, make check payable to Immaculata University and mail to: Business Office, Villa Maria #14, Immaculata, PA 19345.
- In person at the Business Office located in Room #14 in the terrace level of Villa Maria between the hours of 8:30 am - 4:00 pm.
- Payment drop box is located outside the Business Office doors in Villa Maria.
- Payment questions may be directed to studentaccounts@immaculata.edu or by phone at 610-647-4400, ext. 3174.

PRINT YOUR SCHEDULE:

Now that you are registered, **Return to Menu**, and select **Student Detail Schedule** to view and print your schedule. If you are planning to request a student ID Card this semester, the One Card office requires you bring a copy of your printed schedule showing the courses for which you have registered.

ACCESS MY FINAL GRADE:

Final grades must be posted on SSIU in order to be viewed. If your grade is not posted, visit the site periodically after the conclusion of your course. **Student: Student Records: Final Grades: Select a Term and Submit.** Also, the **CAPS and Graduate Student Course Reimbursement** form is available to view and print from the **Student** menu. This form summarizes course-related charges and grades by term and can be used for reimbursement.

ONLINE REGISTRATION RESTRICTIONS/NOTES:

Prerequisites:

If you have not completed the appropriate prerequisite for a course, you will get an error. Please contact the Graduate Office for assistance.

Repeats:

Take care not to register for a course which you have already taken. If you are required to repeat a course in order to achieve a higher grade, please contact the Graduate Office for assistance.

Leave of Absence:

If you are on a leave of absence, you will not be able to register. Please notify the Graduate Office that you are planning to return and want to register. We will reactivate you as an Active student which will then allow you to register online or through the Graduate Office.

Enrichment Status:

Students who are studying only as enrichment with a major of Enrichment, are not permitted to register online. Please contact Sandra Rollison at srollison@immaculata.edu for assistance.

Independent Projects:

All students studying an independent project must register through the Graduate Office. Independent Project forms are available in the Graduate Office.

Dissertations:

Doctoral students studying Dissertation I, II, III or continuous, will receive an email with the CRN number for their section of dissertation so that they can register online. If you need dissertation registration assistance, please call 610-647-4400, Ext. 3215.

Doctoral Internships:

Doctoral students on internship will receive their CRN number (s) via email from the Graduate Office. If you need internship registration assistance, please call 610-647-4400, Ext. 3214.

Offsite/Cohort Students:

Offsite sections (CRN's) are not listed in this publication. You will receive registration instructions from the Special Programs Department. However, if you are going to register for a class on campus, you may follow the instructions as noted in this booklet.

Holds:

You will be required to clear any financial or other holds on your account prior to registering online or through the Graduate Office.

If you have any questions about registration, please contact the College of Graduate Studies office at 610-647-4400, Extension 3215. We will be glad to assist you with your registration.

For technical support, please email the Immaculata University Help Desk at helpdesk@immaculata.edu. Please provide your User ID, Name, Contact Information, and a brief description of your question or issue.

IMMACULATA UNIVERSITY
College of Graduate Studies

Expenses and Payment Policies

Tuition, Charges and Fees – 2019-2020

Application Fee (Master’s)	\$50
Application Fee (Doctoral).....	\$75
Management and Leadership Course Fee	\$95
PSY Exam/EPPP Materials	\$1099

Tuition

Masters Courses.....	\$710 per credit
Doctoral Ed.D Courses.....	\$955 per credit
Doctoral Psy.D Courses.....	\$990 per credit

Practicum and Internship Fees (per semester)

Student Teaching	\$230
Music Therapy.....	\$50/\$100
Nursing	\$110
Dietetic Internship	\$260
Psychology Field Site	\$200

Comprehensive Examination Fee

Master’s	\$75/\$100
Doctoral	\$100/\$160

Graduation Fee..... \$150

Late Payment Fee..... \$30

Returned Check Charge

For an inclusive list of charges visit www.immaculata.edu/admissions/tuition_fees.

STUDENT FINANCIAL RESPONSIBILITY AGREEMENT (SFRA)

All students at Immaculata University are required to agree to the Student Financial Responsibility Agreement once each term before registering for courses. The Agreement is available in the registration area of SSIU (Self-Service IU), accessible through MyIU, and defines the financial terms and conditions associated with course registration. For more information regarding how to accept the SFRA online, refer to page 12.

BILLING AND PAYMENT POLICY

Tuition and fees are due to be paid in full by August 1, 2019. Initial term bill will be generated electronically and in paper beginning July 8, 2019. If registering after July 28, 2019, make payment at time of registration. Subsequent monthly billing statements will be available only electronically through S.S. IU.

Payments are accepted online and additional information can be found on Page 14 under PAYMENT INFORMATION. To avoid account holds and monthly late fees of \$30 be sure to make your payment on time. All financial aid recipients must ensure their financial aid is available by August 1, 2019.

Once registered, a student assumes financial responsibility for charges (see SFRA). Students with outstanding financial obligations are not permitted to attend class, occupy University Housing, and receive grades, teacher certification transcripts or diplomas. Immaculata reserves the right to assign outstanding balances to collection agencies.

Students who are reimbursed by employers may obtain a course enrollment document that includes course information, grade and cost. This document is available online at SSIU; accessible through MyIU. Immaculata University offers an employer billing option to those who qualify. Information is available through MyIU.

IU INSTALLMENT PAYMENT PLAN

You may choose to enroll in the IU Installment Payment Plan which distributes payment across 3 due dates within the term. Enrollment forms are available online through MyIU. There is a \$25 non-refundable installment plan enrollment fee that is due immediately; this fee is not included as part of the installment payment plan. To avoid account holds and a monthly late fee of \$30, please remit payment at time of enrollment. For your convenience payments are accepted online through Self Service IU (SSIU).

Installment payments due: August 1, 2019, September 1, 2019, October 1, 2019

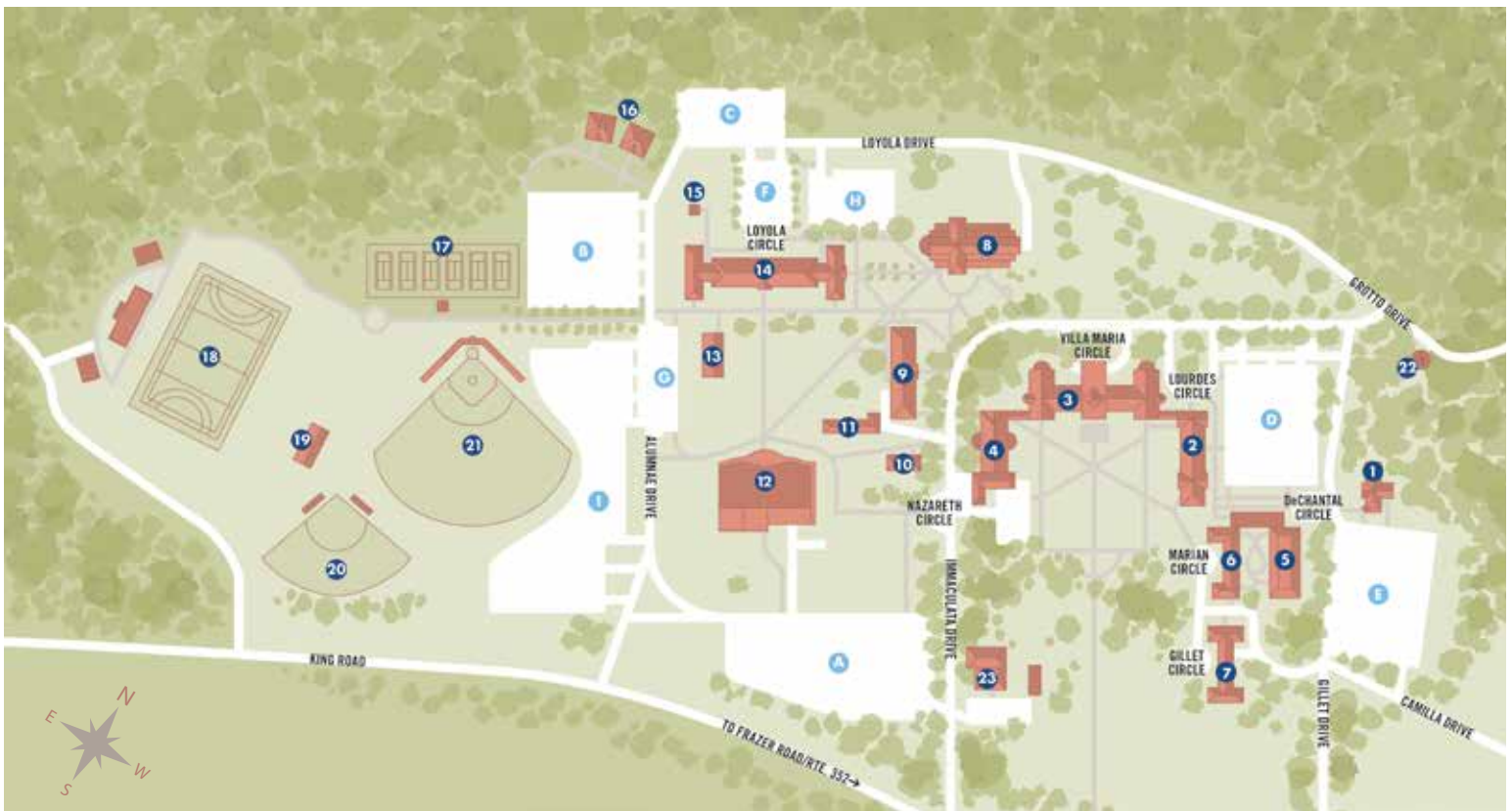

1145 KING ROAD
 IMMACULATA, PA 19345
 USE MALVERN, PA 19355
 FOR GPS PURPOSES

- A. Alumnae Hall General Parking, Freshmen
- B. General Parking Area
- C. General Parking Area
- D. Lourdes Employee Parking Area; administration, faculty, employees and visitors. CLL, graduate and commuter students ONLY may park in this lot between 4 and 11 PM weekdays.
- E. Upper Classmen-Resident Students Parking Area
- F. Faculty/Administration Parking Area
- G. Faculty/Administration Parking Area
- H. General Parking Area; no overnight parking
- I. General Parking Area

- 1. Lillian P. Lettiere Center (Admissions and Financial Aid)
- 2. Lourdes Hall
Campus Safety & Protection
Great Hall
Immaculata Room
Office of Technology Services (Help Desk)
- 3. Villa Maria Hall
Blue Room
Business Office
Canon Copy Center
Green Room
Human Resources
Memorial Hall
Music Hall

- Pathways to Success
Post Office
Registrar
Residence Halls
Academic Advisement (Undergrad)
- 4. Nazareth Hall
Chapel
Dining Hall (Main)
Dining Room (Guest)
- 5. DeChantal Residence Hall
Campus Ministry
Student Life Offices
- 6. Marian Residence Hall
- 7. Gillet Hall
IHM Faculty Residence

- 8. Gabriele Library
Career Development
Duffy's Cut Museum
ImmacuLatté Café
Learning Commons
Media Classroom
Writing Center
- 9. Good Counsel Hall
Follett Campus Bookstore
College of Adult Professional Studies
Administrative Offices
- 10. Mary A. Bruder Center
Counseling Services
Student Wellness Center

- 11. Faculty Center
- 12. Alumnae Hall
Athletic Offices
Athletic Training Facility
Cue and Curtain Office
Fitness Center
Gymnasiums
Pool
Theater
- 13. Loyola Modular Structure
- 14. Loyola Hall
College of Graduate Studies
Administrative Offices
Math Center
POD Market
(Provisions on Demand)

- 15. McIntyre Greenhouse
- 16. West Campus Housing
- 17. Tennis Courts
- 18. Draper Walsh Stadium
- 19. Mighty Macs Training Facility
- 20. Softball Field
- 21. Baseball Field
- 22. Lourdes Grotto
- 23. Power House



1145 KING ROAD
IMMACULATA, PA 19345
USE MALVERN, PA 19355
FOR GPS PURPOSES

Directions to Immaculata University *(minutes from Exton, West Chester, and Paoli, PA)*

By Car

Rte 30 Lower Merion/Villanova:

Take Rte 30 W/Lancaster Ave towards Paoli/Exton.
Continue on Rte 30 W/Lancaster Ave to Rte 352 S/Sproul Rd.
Turn left onto Rte 352 S/Sproul Rd. Follow directions from
Rte 352 & 30.

Rte 30 Exton/Downingtown:

Take Rte 30 W/Lancaster Ave towards Philadelphia.
Continue on Rte 30 E past Rte 202 to Rte 352 S/Sproul Rd.
Turn right onto Rte 352 South/Sproul Rd. Follow directions
from Rte 352 & 30.

From West Chester Pike (Rte 3):

Travel east or west to Rte 352; follow Rte 352 N.
Turn left at light onto King Road. University is one mile on right.

From King of Prussia:

Take Rte 202 S to Rte 29 Malvern exit (follow Immaculata University
sign - 2nd exit); bear right to Rte 29; turn right on Rte 29; at 3rd light,
turn right onto Rte 30 W. Go to Rte 352 S, turn left. Follow directions
from Rte 352 and Rte 30.

From Philadelphia:

Take Schuylkill Expressway (I-76) West to Rte 202 S towards
West Chester. Follow the King of Prussia directions.

Turnpike (I-276) West:

Travel to the Downingtown exit 312; take Rte 100 S to
Rte 30/Lancaster Ave.; turn left on Rte 30 E/Lancaster Ave.
to Rte 352/Sproul Rd; turn right on Rte 352 S/Sproul Rd;
follow directions from Rte 352 & Rte 30.

Turnpike (I-276) East:

Follow the PA Turnpike to the Valley Forge Exit (326).
Once past the tolls, follow Rte 202 S towards West Chester.
Follow the King of Prussia directions.

From Wilmington & I-95:

Travel north on Rte 202 to the Rte 30/Frazer Exit;
turn right on Rte 30 E/Lancaster Ave and continue to
Rte 352/Sproul Rd; turn right on Rte 352/Sproul Rd;
follow directions from Rte 352 & Rte 30.

From Rte 352 & Rte 30:

Travel south on Rte 352. Proceed under the
railroad bridge to the first light which is King Road.
Turn right onto King Road. Immaculata is one mile on
the right.

By Train, Bus, Taxi

From Center City Philadelphia:

Take SEPTA R5 train west to Paoli.
SEPTA bus 133 runs from King of Prussia through
Paoli to the University. For taxi service from Paoli,
call 610-644-2564.

By Air

Immaculata is approximately a 50-minute drive from
Philadelphia International Airport, where limousine service
is available to the Paoli/Malvern area. The SEPTA R1 train
from the airport connects with the R5 train (Paoli Local).

